



THE BEET GOES ON !

A.Chiarelli, T. Lecourt, E. Cailliau, L. Ado

HOW CAN WE BRING FOOD PRODUCTION  
INTO THE CITY?

---

HOW CAN FOOD PRODUCTION  
BECOME PART OF THE URBAN SYSTEM?

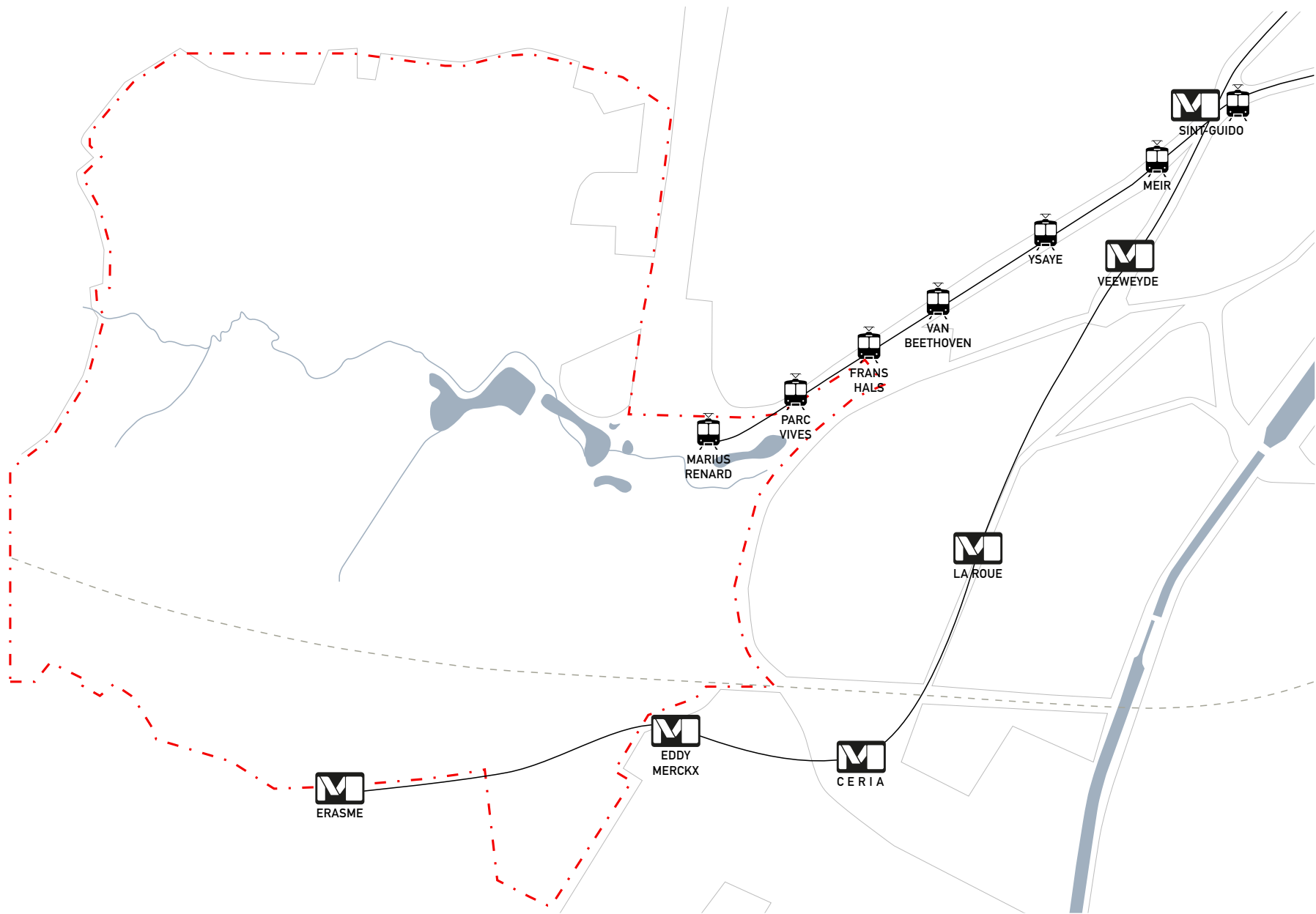

mobility

the area is potentially well connected through tram and metro



green areas

the existing different green spaces are disconnected one from the other





urban potentialities  
research, pharmacological-medical laboratories,  
zemu areas and ferm du chaudron coexist but are disconnected



existing elements

the site is full of potential but lacks of synergies between its elements

COUNTRYSIDE

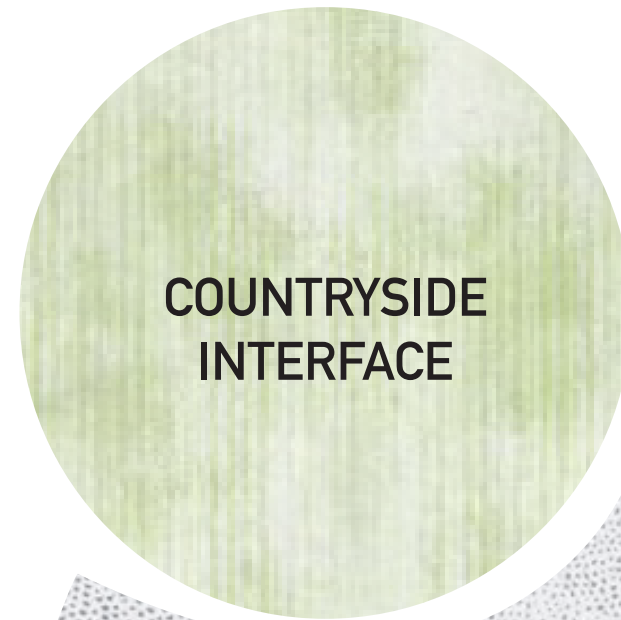

COUNTRYSIDE  
INTERFACE

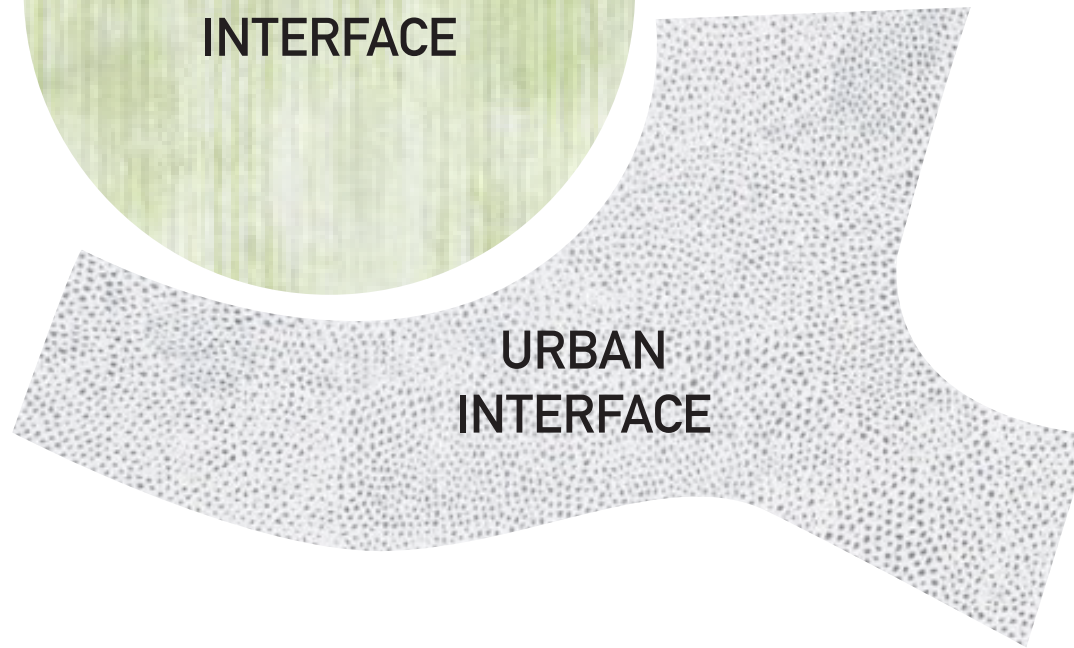

CITY

URBAN  
INTERFACE

strategic interface

an interface between city and countryside is identified

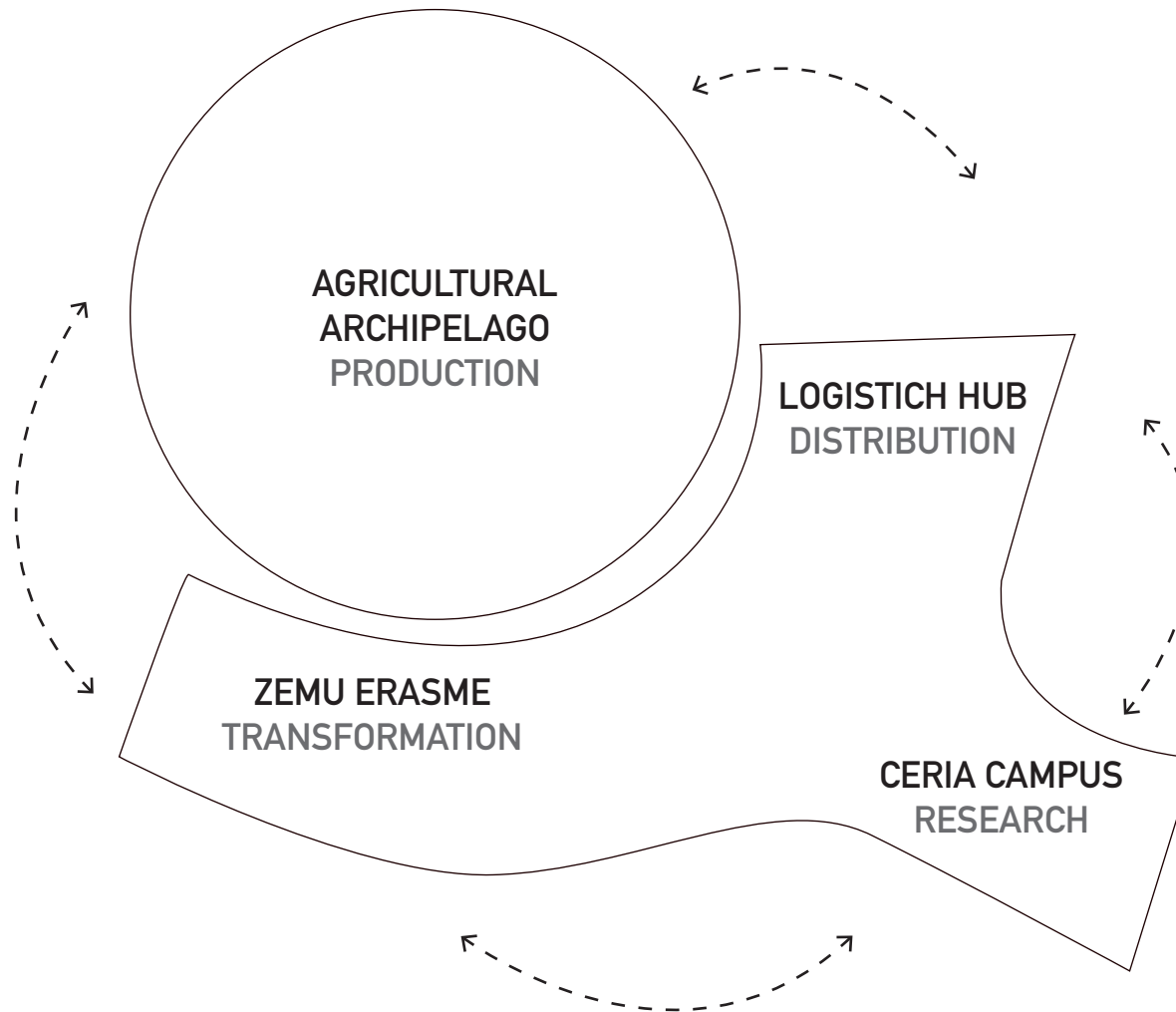

from strategy to synergies  
the interface fosters the creation of a circular economical ecosystem

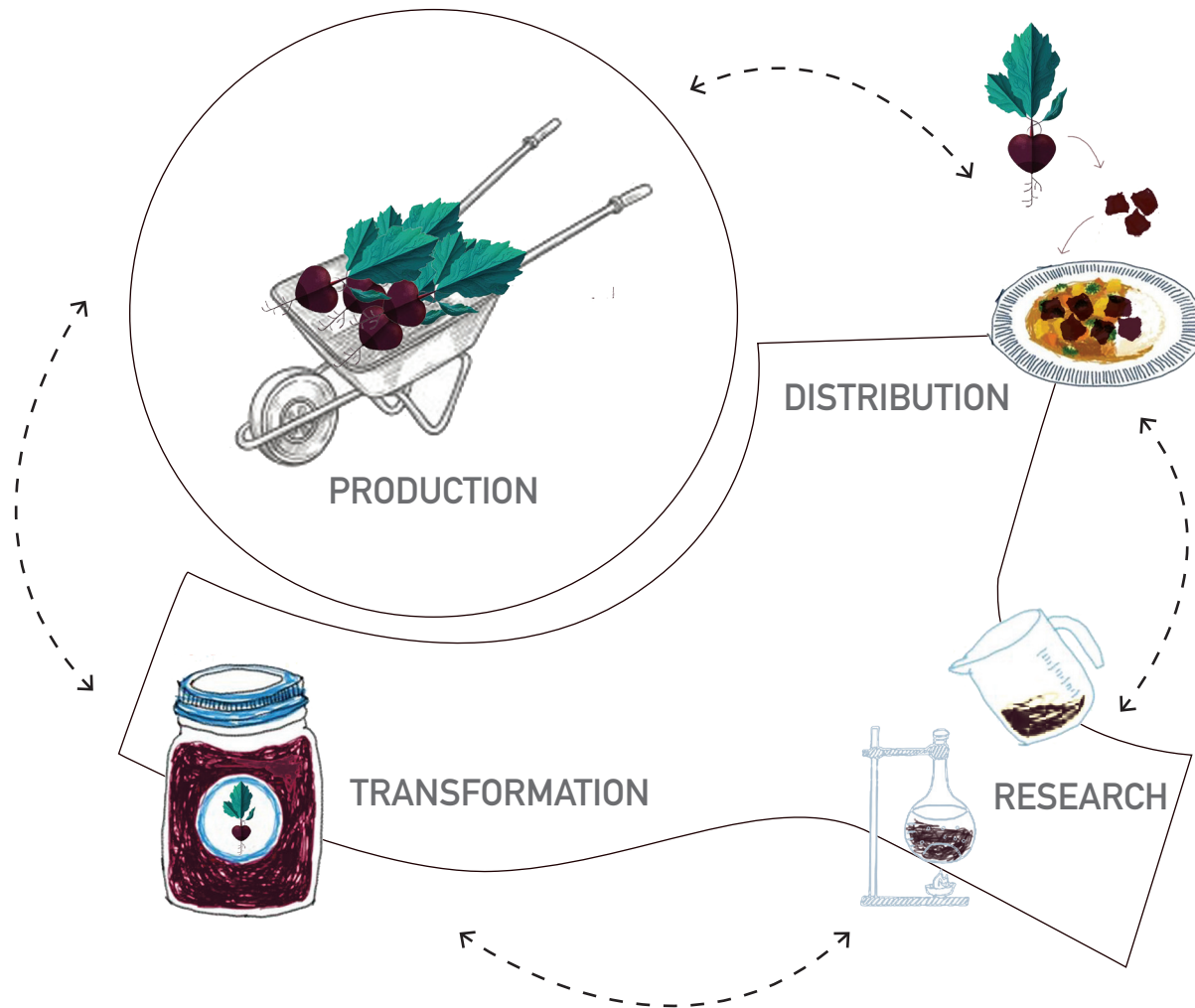

the beet cycle  
vegetables become part of the system  
where each area informs the others

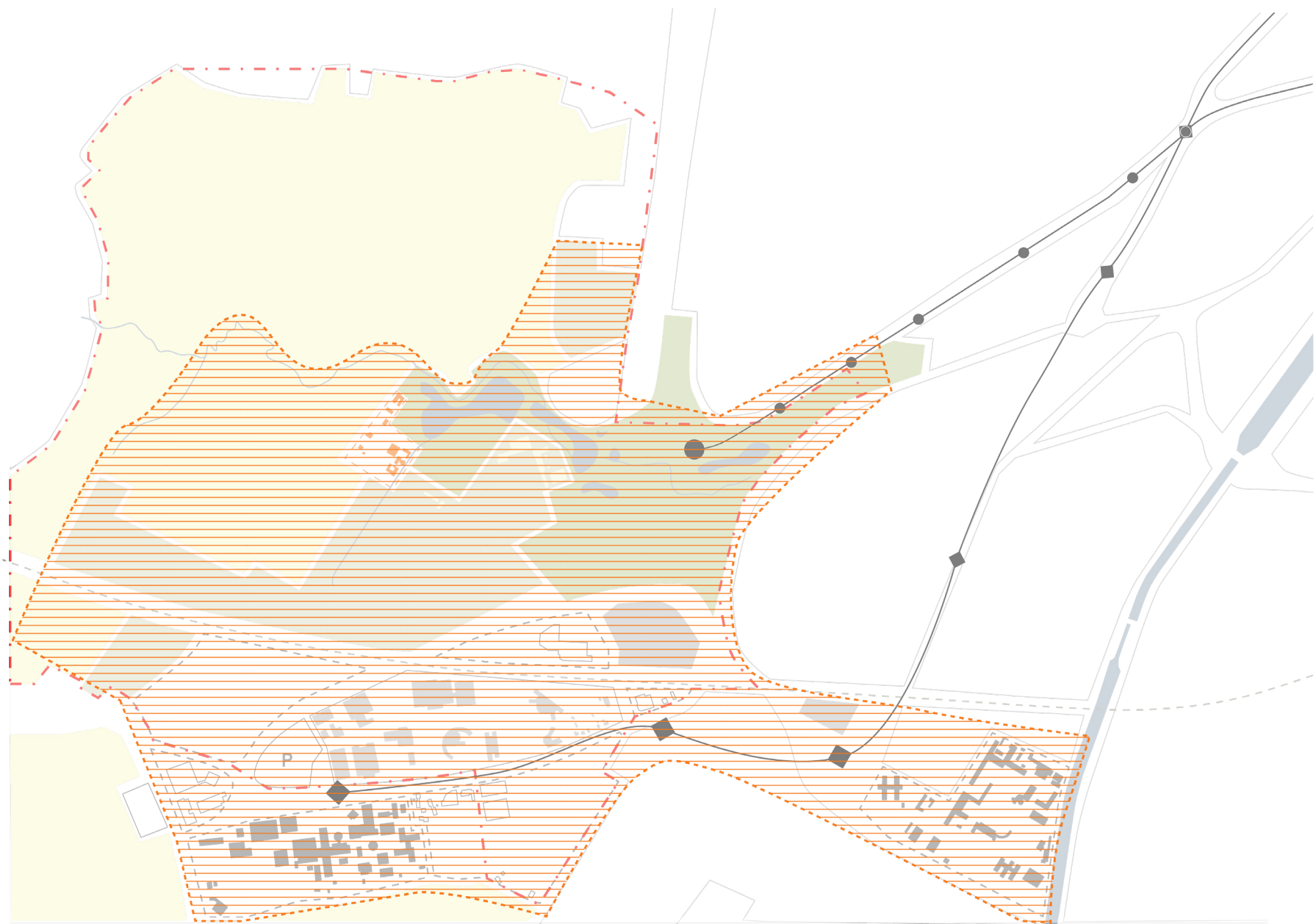

interface

each of elements identified during the analysis become  
part of the interface

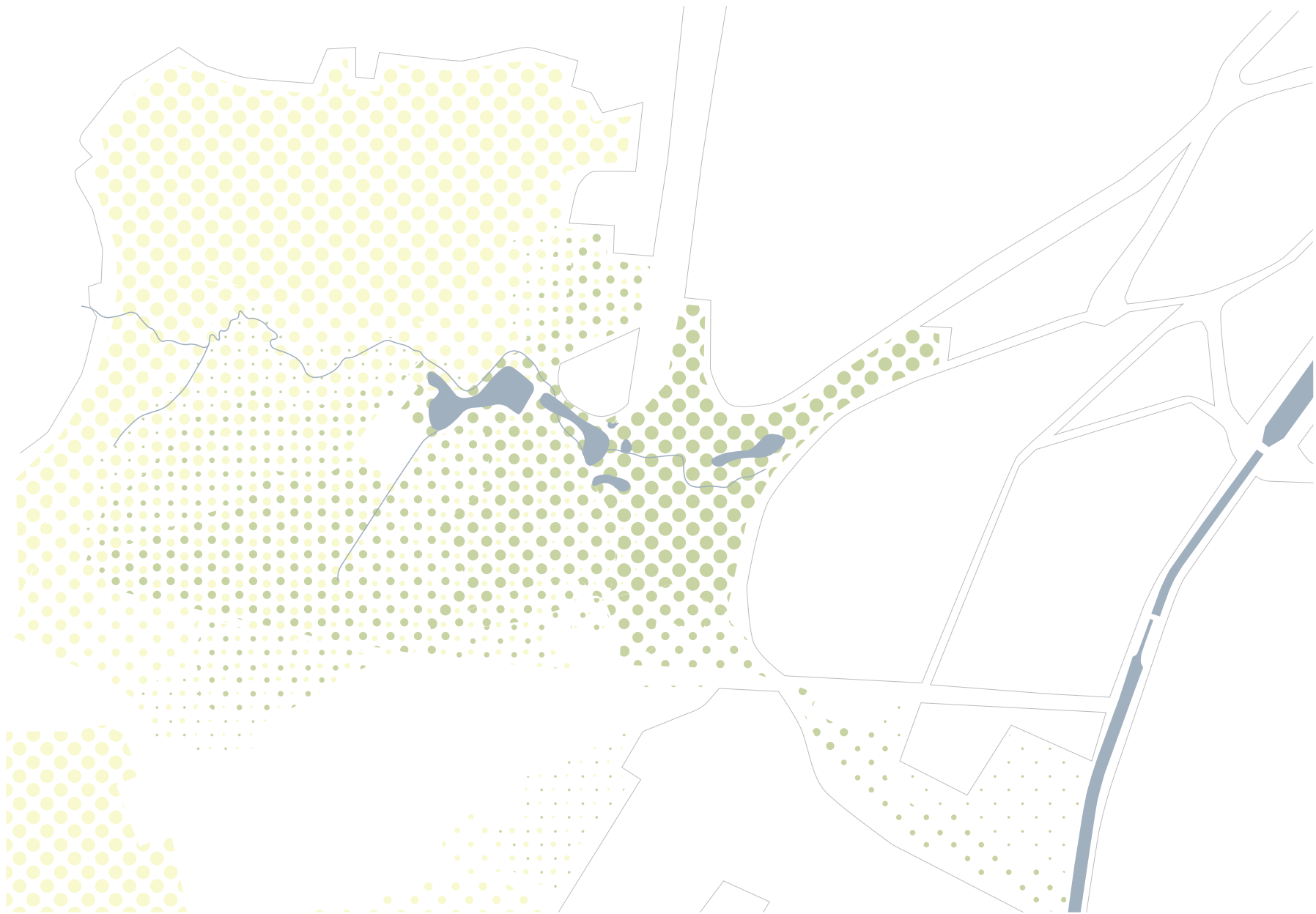

green gradients

the park with sports facilities and the fields contaminate each other  
and the surrounding city, generating a third landscape - the food scape



urban cluster

developments of the zemu areas complete the urban-farm fabric  
empowering the transformation facilities already existing in the area



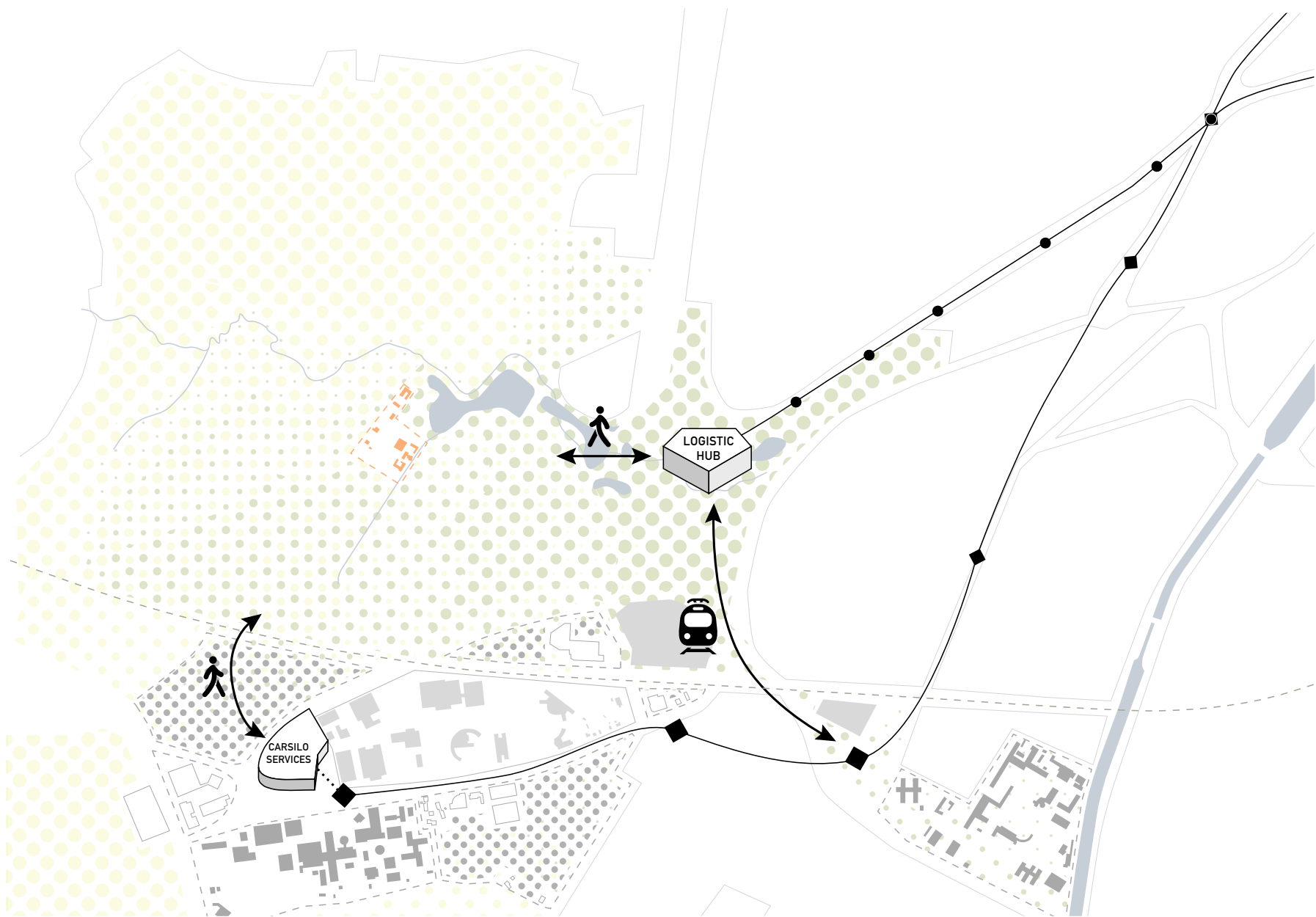

connecting the dots

two anchors, mixing logistic and services, become the gates to the health park  
a shuttle system connects tram and metro networks, enhancing the area accessibility

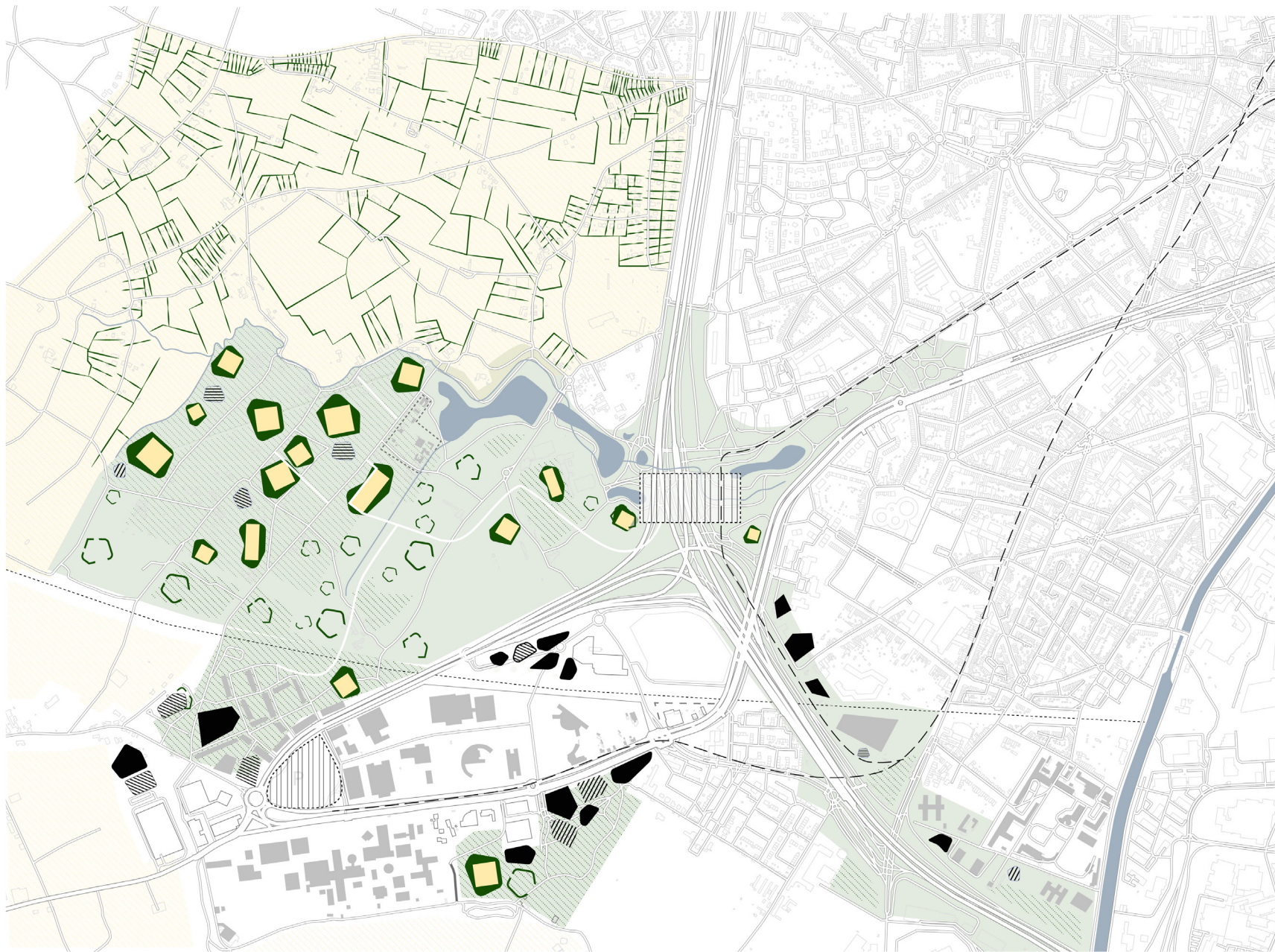

strategic plan



production  
agricultural archipelago



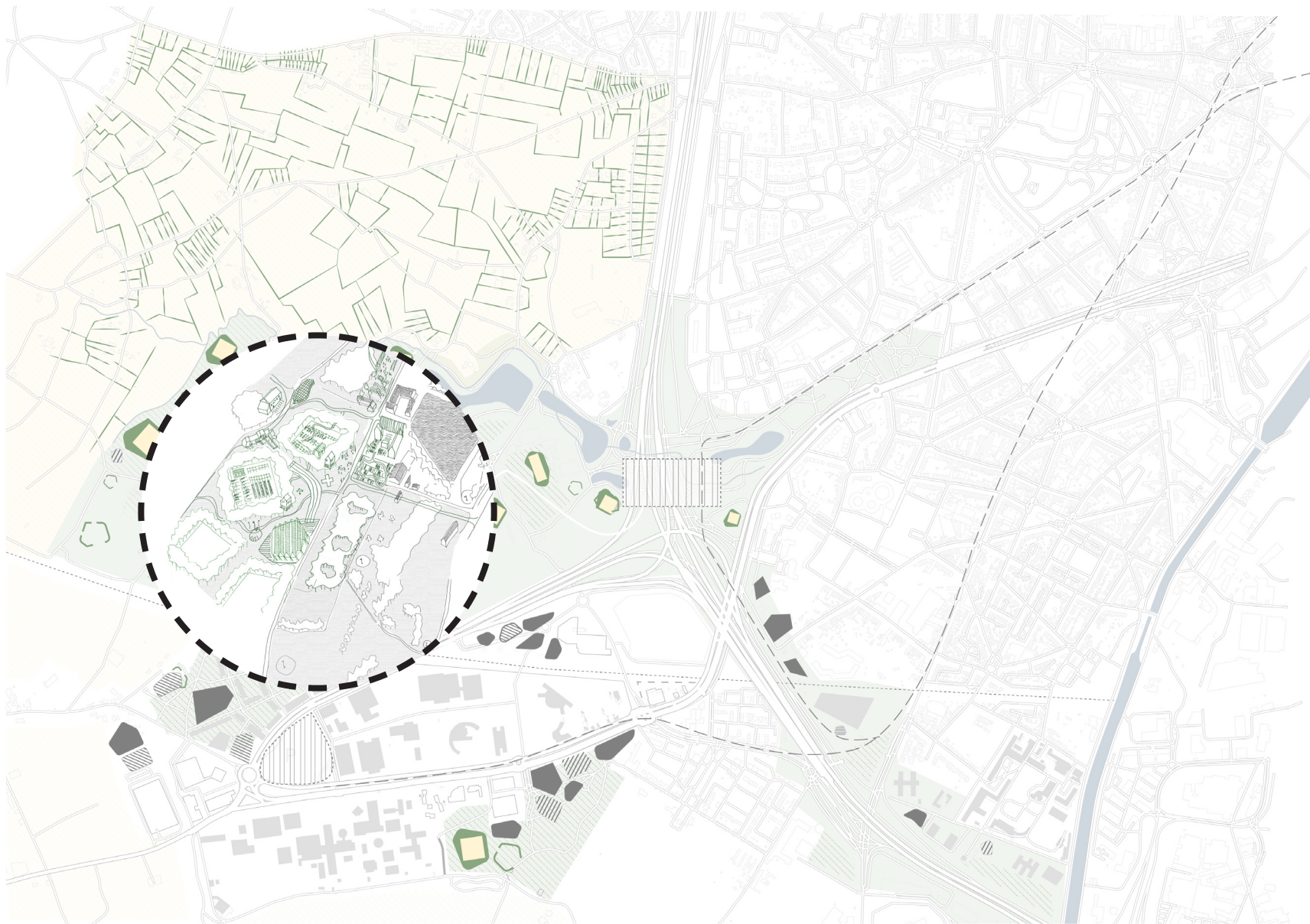

production  
agricultural archipelago



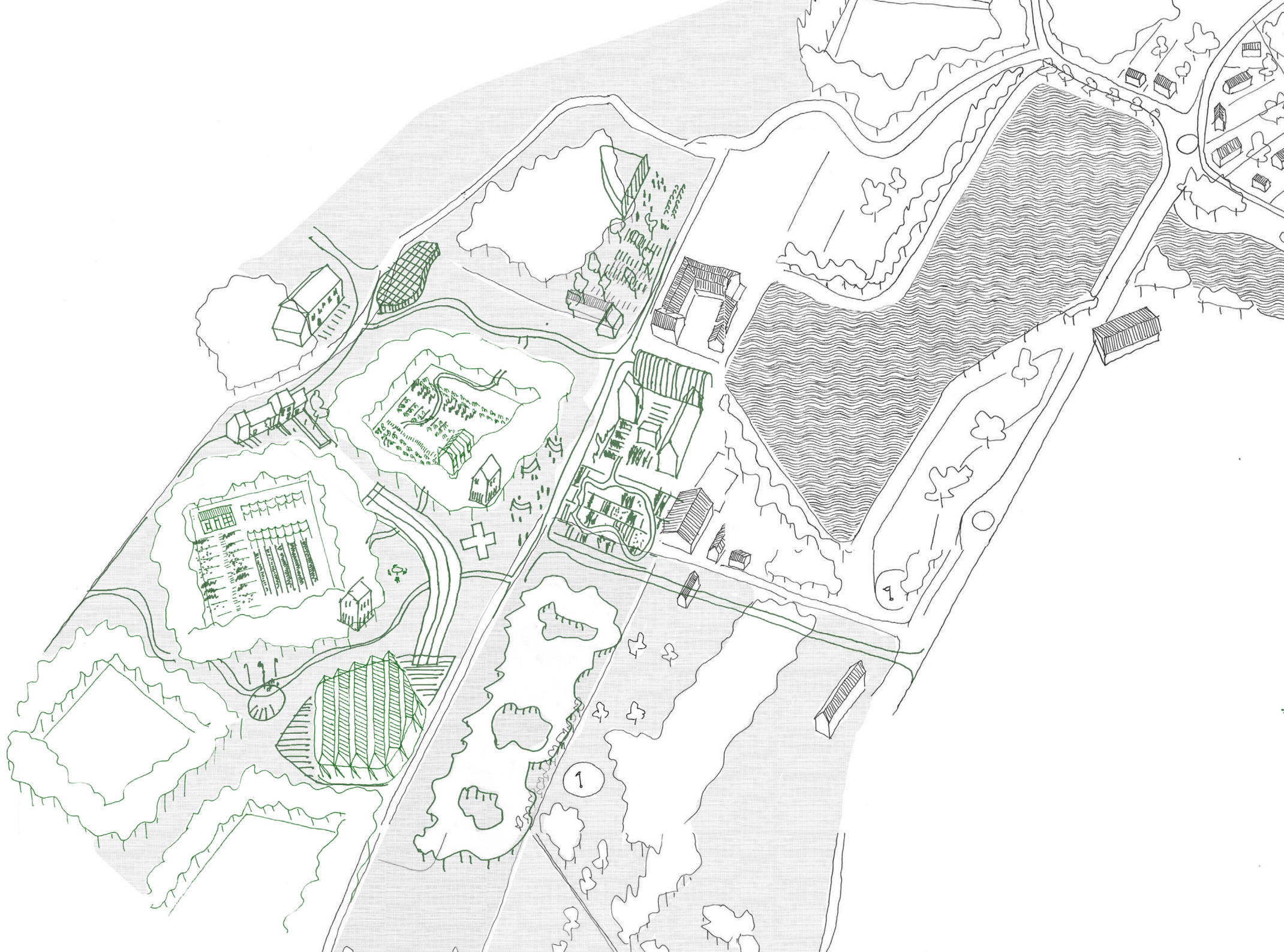



research and transformation  
campus ceria - zemu erasme





research and transformation  
campus ceria - zemu erasme







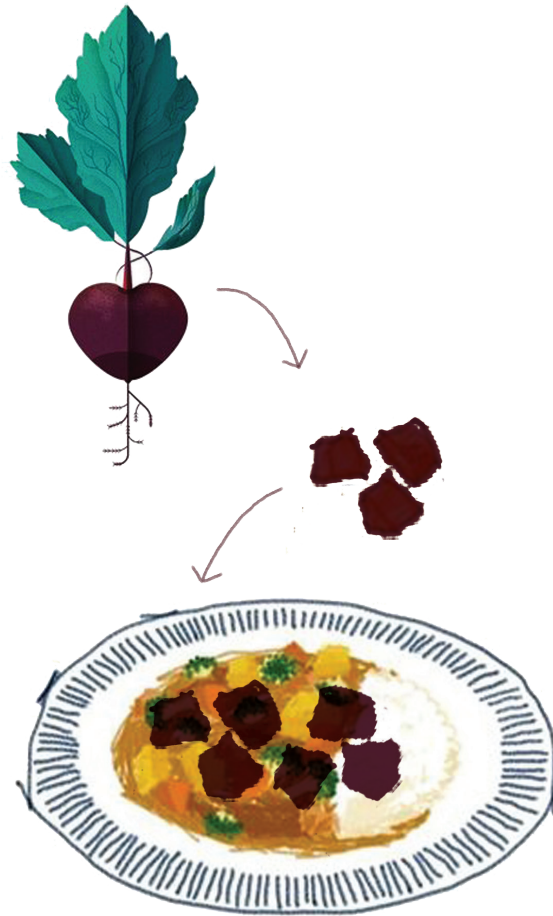

distribution  
logistic hub



distribution  
logistic hub





