

# SAN DONA' VENEZIA (IT)

1

# SAN DONA' VENEZIA (IT)

2

# SAN DONA' VENEZIA (IT)

3

## Living Between the Lines

The transfer of the current ATVO to a new transport hub represents a challenge for San Dona'. From an urban point of view, such transformation is a significant impact on urban dynamics. Consequently, the redevelopment of the area is of vital importance to define new ways of living in the contemporary city.

Lo spostamento dell'attuale spazio ATVO e il ricambio della stazione delle corriere in un nuovo polo intermodale, rappresenta un'occasione unica per il comune di San Dona'. Dal punto di vista urbanistico e logistico, tale trasformazione ha un forte impatto sul riassetto delle dinamiche urbane. Di conseguenza è di vitale importanza una rigenerazione integrale dell'area per definire i nuovi modi di vivere e integrare la città contemporanea.

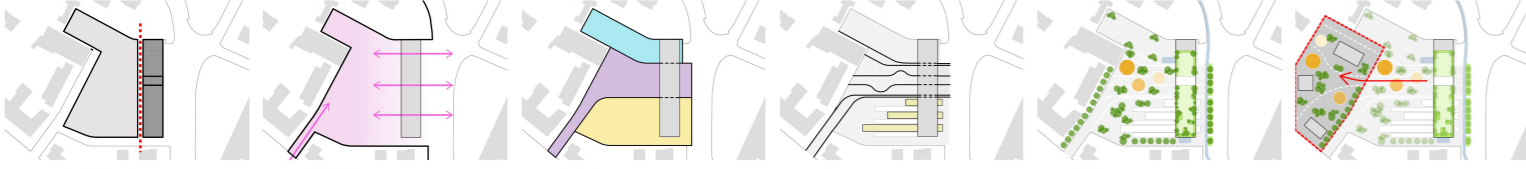

## AREE VERDI E ACQUA / GREEN AREAS AND WATER

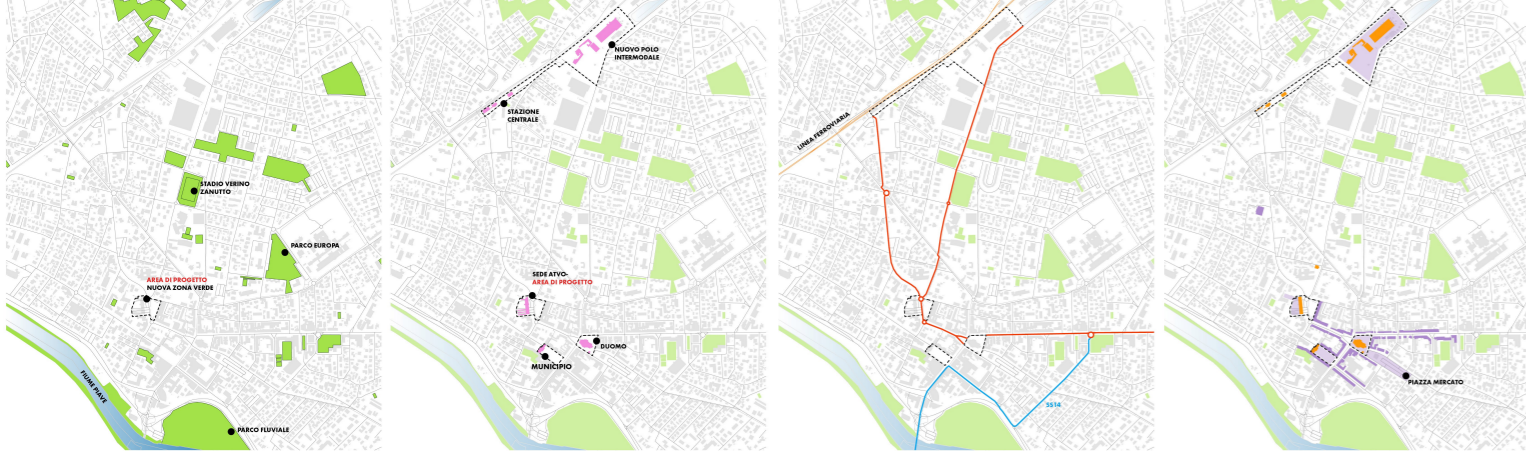

## The Piazza / La Piazza

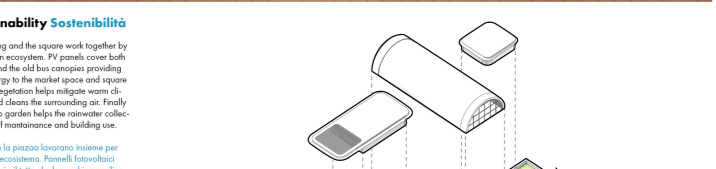
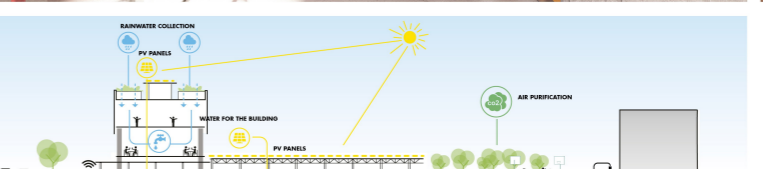
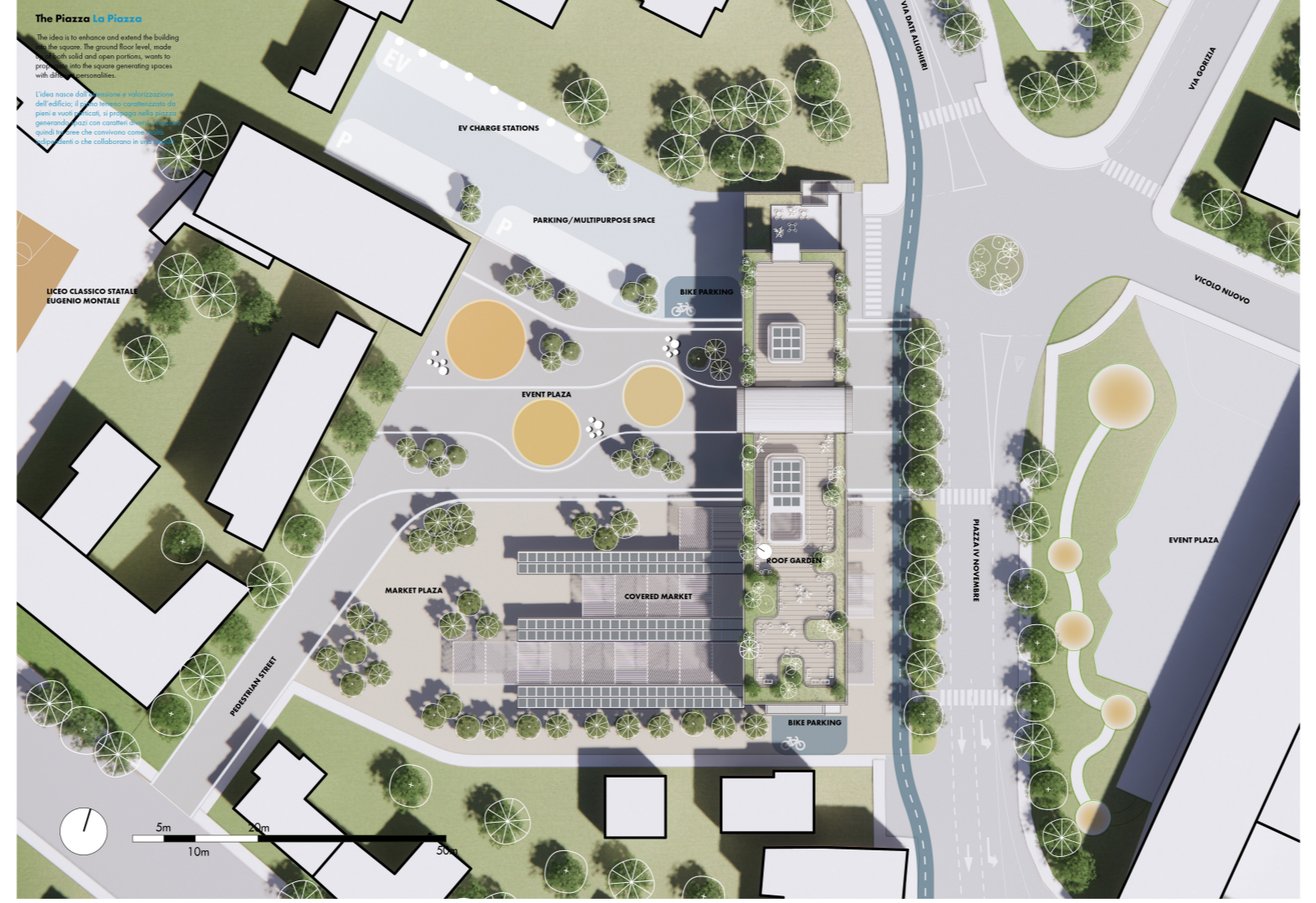
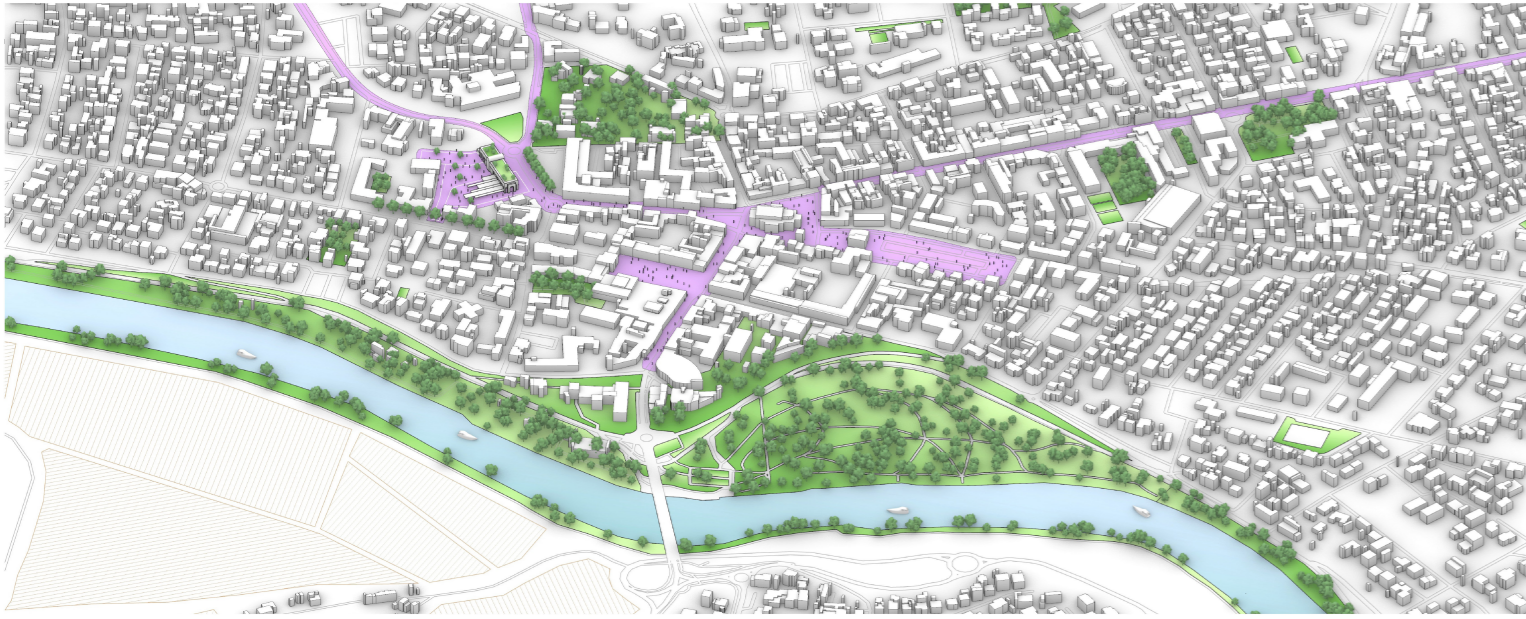
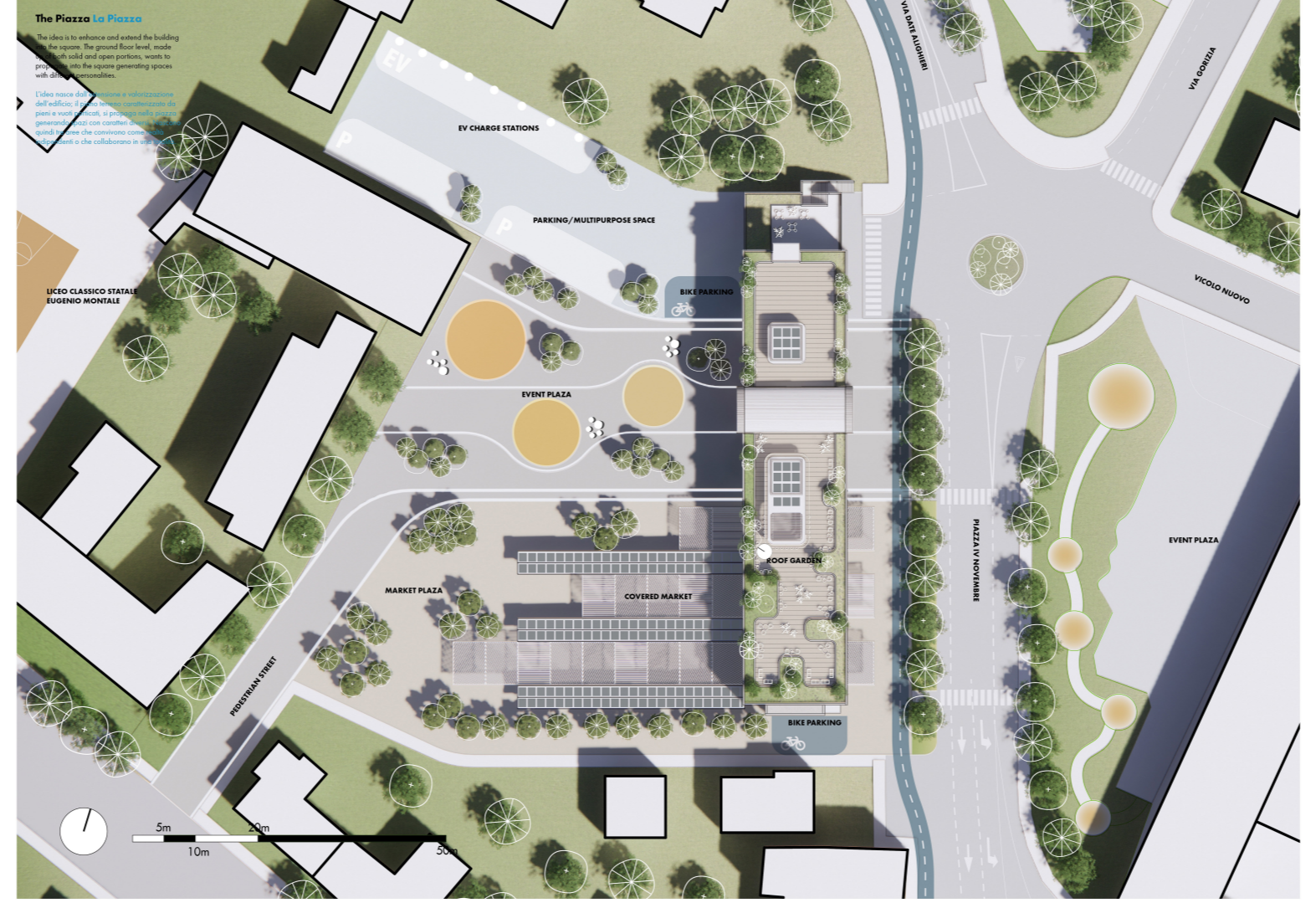

## The Building L'Edificio

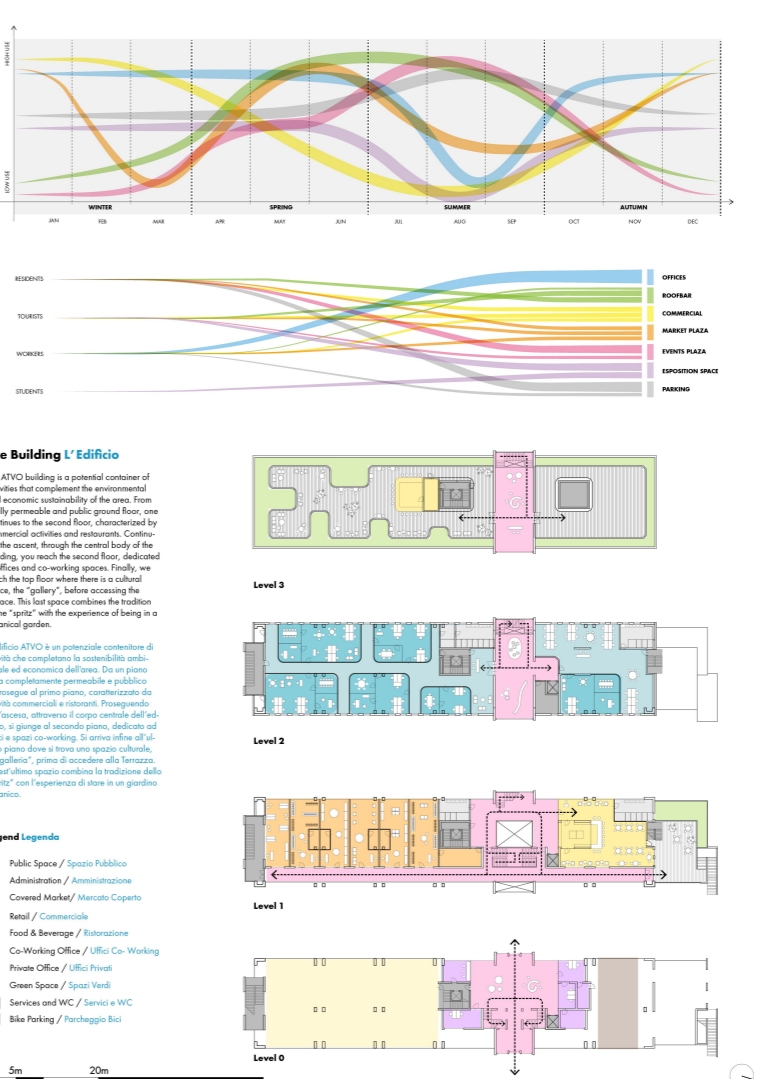

## The Gallery / La Galleria

