

THE ADAPTABLE CITY / 1

EUROPAN 12
RESULTS



ANALYSIS OF A SESSION

The first part of the catalogue formulates interpretations around the six topics of the session (Dynamic urban platforms, Heritage of the future, From mono-large to multi-mix, Ecorhythms, In-between time, Networked territories), accompanied by the perspectives of a number of European experts.

WINNING PROJECTS

The second part of the catalogue is a presentation of the 170 winners, runners-up and special mentions projects from the twelfth session, classified into site families (Dynamic urban platforms, Heritage of the future, From mono-large to multi-mix, Ecorhythms, In-between time, Networked territories). It provides access to all the session results with the points of view of the team and the jury.

CONTENTS

INTRODUCTION 4

DIDIER REBOIS, ARCHITECT, TEACHER,
EUROPAN EUROPE GENERAL SECRETARY

MAP OF SITES 8

ANALYSIS OF A SESSION

Reshaping shared spaces 242

CONVERSATION WITH OLIVER SCHULZE,
ARCHITECT, TEACHER (DK)

Linking with uses 249

CONVERSATION WITH JOSÉ MARÍA EZQUIAGA,
ARCHITECT, URBANIST, TEACHER (ES)

Cultural interferences 256

CONVERSATION WITH ENRIQUE SOBEJANO,
ARCHITECT, TEACHER (ES)

Common resources and mutation 263

CONVERSATION WITH MATHIEU DELORME,
ENGINEER, LANDSCAPE ARCHITECT, URBANIST,
TEACHER (FR)

Rhythms and timeframes 269

CONVERSATION WITH CHRIS YOUNÈS,
PHILOSOPHER, ANTHROPOLOGIST,
TEACHER (FR)

WINNING PROJECTS

170 projects: 43 winners, 63 runners-up
and 64 special mentions

Dynamic urban platform

AALBORG (DK) XX
Winner - *Das Andere*
Runner-up - *A collective storyline*
Special mention - *Aalborg Vest activated!*

BITTERFELD-WOLFEN (DE) XX
Winner - *Vanished villages – Collective city*
Runner-up - *Urbanochory*
Special mention - *Eclectic Islandse*

BUDAPEST (HU) XX
Runner-up 1 - *Manual towards a clumsy city*
Runner-up 2 - *Chain reaction*
Special mention - *Tune up, Zuglò!*

DON BENITO (ES) XX
Winner - *Don Benito's patio*
Runner-up - *Shadow*
Special mention 1 - *West of Spain*
Special mention 2 - *Structure*
Special mention 3 - *Be void my friend*

GJILAN (KO) XX
Runner-up - *Welcome to urban wellness!*
Special mention - *Good old times*

KRISTINEHAMN (SE) XX
Winner - *Responsive system*
Runner-up - *The centre. The path. The field of action*

MARSEILLE (FR) XX
Runner-up 1 - *Concomitance*
Runner-up 2 - *A new urban village*
Special mention - *Il n'y a que mail qui maille*

SAINT-HERBLAIN (FR) XX
Winner - *Metacentre: the emergence of a garden territory*
Runner-up - *Permaculture*
Special mention - *Punctuations...*

SCHIEDAM (NL) XX
Runner-up 1 - *A new start with old genes*
Runner-up 2 - *Complete Schiedam*

WITTENBERGE (DE) XX
Winner - *Re-Hub Wittenberge*
Runner-up - *Take part in wITtenberge*
Special mention - *Seeding biodiversity*

Heritage of the future

AMSTETTEN (AT) XX
Winner - *Open*
Runner-up - *Rail banks river*
Special mention - *Periscopes*

ASKER (NO) XX
Winner - *Kaleidoscope*
Runner-up - *Ola K Asker*
Special mention - *The leaf*

COUVET (CH) XX
Winner - *Dubimpulse*
Runner-up - *Wood de Travers*
Special mention - *Une nébuleuse de petits bâtiments*

HAMMARÖ (SE) XX
Winner - *Paths*
Runner-up - *Satellyzinh Hammarö*
Special mention 1 - *Forest community*
Special mention 2 - *Identicity plug-pump-flow*

KØBENHAVN (DK) XX
Winner - *Our courtyard in the street*
Runner-up - *Sprouting cityblocks*
Special mention 1 - *Copenhagen wetlands*
Special mention 2 - *Passage of time*

NÜRNBERG (DE) XX
Winner - *Yourban*
Runner-up - *Sonnenblume*
Special mention - *Meet thy neighbour*

REGIONALE 2016 (DE) XX
Runner-up 1 - *Make yourself at home*
Runner-up 2 - *Kein Land für alte Männer*
Runner-up 3 - *Rising stars*
Special mention - *Adaptable – Cooperative – Urban smile*

WARSZAWA (PL) XX
Winner – *Two scales*
Runner-up - *UrbanPermaculture*
Special mention - *In-between days*

From mono-large to multi-mix

GRAZ (AT) XX
Runner-up 1 - *The bucket list – Feel the city*
Runner-up 2 - *Polyrhythmic fields*
Special mention - *Smart base*

GRONINGEN (NL) XX
Winner - *Prelude*
Runner-up - *Uploading city*

HANINGE (SE) XX
Winner - *Parklife*
Runner-up - *Traffic island*
Special mention 1 - *More than a lot*
Special mention 2 - *5 ways*

HEIDELBERG (DE) XX
Winner - *Startband*
Runner-up - *U-Living*
Special mention - *Campbell Fundamental*

HELSINKI (FI) XX
Winner - *Asclepeion*
Runner-up - *Vesisukkula – Water shuttle*
Special mention 1 - *Sensorial hug*

KAISERSLAUTERN (DE) XX
Winner - *Pattern for progress*
Runner-up - *A parlour game*
Special mention - *PFA.FF.: Preserve Fable About Architecture Factory Faciilities*

MARLY (CH) XX
Winner - *Le parc des Falaises*
Runner-up - *Dancing density*
Special mention 1 - *Slow poles*
Special mention 2 - *Urban archipelago*

URRETXU-IRIMO (ES) XX
Winner - *Pizutako Irimo*
Runner-up - *Tempos de colonization*
Special mention 1 - *Reversibilidad eCOlectiva*
Special mention 2 - *Encuentros en la tercera fase*
Special mention 3 - *Everything anytime*

WIEN – SIEMENSÄCKER (AT) XX
Winner - *Cluster / Streetscape*
Runner-up - *Urban software*

Ecorhythms

BÆRUM (NO) XX
Winner - *Social Riverscape*
Runner-up - *Elasti-City*
Special mention - *Hamang Riparian zone*

FOSES (FR) XX
Winner - *The amateur*
Runner-up 1 - *Crossing-Over*
Runner-up 2 - *Par la grande porte*

HÖGANÄS (SE) XX
Winner - *Twinphenomena*
Runner-up - *Urbedible*
Special mention - *Höganäs, unresolved, reconnected, resilient, urbanity*

KAUFBEUREN (DE) XX
Winner - *Fasten your seatbelt!*
Runner-up - *Long-lasting landing landscaping*
Special Mention - *Air sharing*

KONSTANZ (DE) - KREUZLINGEN (CH) XX
Winner - *Der weg ist das ziel!*
Runner-up - *2K24*
Special mention - *Joint promenade*

MILANO XX
Winner - *Landscape transition*
Runner-up - *Porto Agricolo*
Special mention 1 - *San Rocco*
Special mention 2 - *Visioning Porto Di Mare 2035*
Special mention 3 - *Pomerio*
Special mention 4 - *RoomScape_Milano*

PARIS - SACLAY (FR) XX
Winner 1 - *Negotiation lab*
Winner 2 - *Reversing the grid*
Special mention - *Gather in/parcel out: 2 ways to differentiate development*

VICHY VAL D'ALLIER (FR) XX
Winner - *Pioneer fringes*
Runner-up - *Clearings archipelago, ...*
Special mention - *Arboripôle5: an eco-conscious reappropriation*

XX **In-between time** XX
ASSEN (NL) XX
Winner - *Embrace the present*
Runner-up - *Urban nature*
Special mention - *Waste?land*

XX DONAUWÖRTH (DE) XX
Winner - *Kept soil*
Runner-up - *Multiple city*

KUOPIO (FI) XX
Winner - *Savo Nueva*
Runner-up - *Somewhere over the train flow...*
Special mention 1 - *Run to the hills*
Special mention 2 - *Meetings and greetings*
Special mention 3 - *Cronotopia*

XX ROUEN (FR) XX
Winner - *Que m'Anquetil ?*
Runner-up - *Rouen: "on the move"*
Special mention - *A station for the two banks*

XX SERAING (BE) XX
Winner - *Synergy*
Special mention - *Between Meuse and Forest... the weft of possibles*

XX VILA VIÇOSA (PT) XX
Winner - *Between landscapes*
Runner-up - *Tupperware party*

XX WIEN – KAGRAN (AT) XX
Runner-up 1 - *Monument in fertile country*
Runner-up 2 - *Kaleidoscope*
Runner-up 3 - *En pointe!*

Networked territories

XX ALMADA - PORTO BRANDÃO (PT) XX
Almada - *Porto Brandão*
Winner - *Porto Novo*
Runner-up - *Punctuation*
Special mention - *Timeline*

XX ÅS (NO) XX
Winner - *En, to, tre... rød lys!*
Runner-up - *Hortus conclusus*
Special mention 1 - *All eyes on Ås*
Special mention 2 - *Straight line*

XX BARCELONA (ES) XX
Winner 1 - *Rambles verdes*
Winner 2 - *Urban insertions*
Special mention 1 - *Right to Infrastructure*
Special mention 2 - *Tafetán*

XX CINEY (BE) XX
Runner-up 1 - *Rubik's*
Runner-up 2 - *Chute*
Special mention 1 - *Specific indetermination*
Special mention 2 - *Walk the line*

KALMAR (SE) XX
Winner - *Conservation, densification and complexity*
Runner-up 1 - *Bombelek*
Runner-up 2 - *In-between landscapes*
Special mention 1 - *forts of fanaticism*
Special mention 2 - *Kon // Kalmar*

XX MANNHEIM (DE) XX
Winner - *Mannheim's connection*
Runner-up - *Re-Evolution*
Special mention - *Inverse boulevard*

XX MÜNCHEN (DE) XX
Winner - *Wohnen am Ring*
Runner-up - *COMBined process*
Special mention - *Schachbrettspiel*

XX PARIS (FR) XX
Runner-up 1 - *Green belt dilatation*
Runner-up 2 - *In transition – A local metropolis*
Runner-up 3 - *Collective unit*

XX VENEZIA (IT) XX
Runner-up 1 - *Urban grafts*
Runner-up 2 - *The territorial threshold*
Runner-up 3 - *Percorsi per riqualificare*
Special mention 1 - *Match boxes*

XX Special mention 2 - *Urban Channels*
Special mention 3 - *Sewing threads*
Special mention 4 - *The anatomy lesson*

INDEX

JURIES XX

EUROPAN SECRETARIATS XX

XX CREDITS XX

Belgique / België / Belgien (BE)

- 1** CINEY XX
- 2** SERAING XX

Danmark (DK)

- 3** AALBORG XX
- 4** KØBENHAVN XX

Deutschland (DE)

- 5** BITTERFELD-WOLFEN XX
- 6** DONAUWÖRTH XX
- 7** HEIDELBERG XX
- 8** KAISERSLAUTERN XX
- 9** KAUFBEUREN XX
- 10** MANNHEIM XX
- 11** MÜNCHEN XX
- 12** NÜRNBERG XX
- 13** REGIONALE 2016 XX
- 14** WITTENBERGE XX

España (ES)

- 15** BARCELONA XX
- 16** DON BENITO XX
- 17** URRETXU_IRIMO XX

France (FR)

- 18** FOSSES XX
- 19** MARSEILLE XX
- 20** PARIS XX
- 21** PARIS - SACLAY XX
- 22** ROUEN XX
- 23** SAINT-HERBLAIN XX
- 24** VICHY VAL D'ALLIER XX

Italia (IT)

- 25** MILANO XX
- 26** VENEZIA XX

Kosovo (KO)

- 27** GJILAN XX

Magyarország (HU)

- 28** BUDAPEST XX

Nederland (NL)

- 29** ASSEN XX
- 30** GRONINGEN XX
- 31** SCHIEDAM XX

Norge (NO)

- 32** ÅS XX
- 33** ASKER XX
- 34** BÆRUM XX

Österreich (AT)

- 35** AMSTETTEN XX
- 36** GRAZ XX
- 37** WIEN – KAGRAN XX
- 38** WIEN – SIEMENSÄCKER XX

Polska (PL)

- 39** WARSZAWA XX

Portugal (PT)

- 40** ALMADA - PORTO BRANDÃO XX
- 41** VILA VIÇOSA XX

**Schweiz/Suisse/Svizzera/
Svizra (CH)**

- 42** COUVET XX
- 43** MARLY XX

Suomi-Finland (FI)

- 44** HELSINKI XX
- 45** KUOPIO XX

Sverige (SE)

- 46** HAMMARÖ XX
- 47** HANINGE XX
- 48** HÖGANÄS XX
- 49** KALMAR XX
- 50** KRISTINEHAMN XX

Transboundary site

- 51** KONSTANZ (DE) –
KREUZLINGEN (CH) XX



In-between time

Architecture-as-Urbanism for Uncertain Conditions

The concept of the "adaptable city", the theme of Europan 12, is about advocating creative ways to incorporate uncertainty and irresolution into urban design. Indeed, this is the challenge for architecture as it seeks to re-engage with city-making in order to foster urban continuity and cohesion. We call such practice "architecture-as-urbanism" or "architectural urbanism"¹. By re-situating Europan with respect to such "in-house" (Europan) or "outré mer" (overseas) references, we will uncover strategic principles that instigate urban continuities which do not rely on the tangible continuity of the built environment or on any other overall plan, providing alternatives to either the "poeticity of fragmentation"² or the certainty of the master planning mode of operation. Indeed, the results of the Europan 12 session could enrich a relevant international debate. The exploration of twelve winning projects on seven sites under the sub-theme of "In-Between Time", will demonstrate how their strategic approach confronts transition as perpetual urban uncertainty. The sites are: Wien-Kagran, Austria; Seraing, Belgium; Donauwörth, Germany; Vila Viçosa, Portugal; Kuopio, Finland; Assen, Netherlands and Rouen, France.

"Stop-Action Frame" Project Sites

"Cities appear as a stop-action frame: nothing happens for interminable periods, when suddenly we arrive at built results seemingly by fast-forward...like a series of discontinuous jump-cuts the landscape transforms in a sequence of disorienting new frames..."³

Although this quote does not yet fully apply to European cities, it is apparent that stop-action

frame project sites are becoming more frequent in the different Europan sessions. They are mostly abandoned, marginalized sites, at the end of their life cycle. Further on, we will see that such sites are increasingly situated within the stop-action frame economies of cities and countries. A recurrent critique of the Europan institution concerns cities entering the competition with stop-action frame sites where "nothing happens for interminable periods" and asking young, inexperienced architects, and now landscape architects and planners, to "arrive at built results seemingly by fast-forward". Nevertheless, Europan has indeed become one of the rare European platforms to address such complex issues, which are seemingly not easily tackled by the usual municipal *modus operandi*. Often, innovative projects may succeed in mobilising urban actors, in formulating an imagery of possibilities and in creatively contaminating the everydayness of the city. Usually, the formulation of the project brief for each site becomes the instigator of such innovations, as we will see later in relation to the E12 sub-theme "In-Between Time".

Three stop-action frame sites ready for a jump-cut: the Wien-Kagran site in Austria (fig.1)



1 - WIEN-KAGRAN (AT)



2 - SERAING (BE)



3 - DONAUWÖRTH (DE)

is an area squeezed between two big rail infrastructures. It is a somewhat fragmented zone, but with good road access enhanced by the adjacent IKEA store. Vienna's need to house a population influx has increased the pressure to place housing in this area. In Seraing, Belgium (fig.2), the closure of a steel plant has opened up the area to local housing development, based on a master plan prepared by the city to cope with future urban housing pressure. In Donauwörth, Germany (fig.3), the municipality was recently informed that the adjacent military base is to be closed, raising the question of what to do with a site whose scale dwarfs the city centre. The municipality is looking for the phased development of a robust concept that will incorporate the existing military buildings.

Four sites interminably locked in stop-action frames: Vila Viçosa in Portugal (fig.4) is part of a larger territory sidelined and abandoned after the decline of the marble industries. The municipality is looking for alternative ways of reusing the existing site, despite the apparent lack of an urban dynamic. In Kuopio, Finland



4 - VILA VIÇOSA (PT)



5 - KUOPIO (FI)



6 - ASSEN (NL)

(fig.5), a school and athletic facilities situated on a site cut off from the rest of the city by railway lines, have come to the end of their life cycle. The municipality seems perplexed about the future of this area, except the need for it to be reconnected to the city. In Assen (fig.6), but also – because of the financial crisis – across most of the Netherlands, the municipality is shifting from a policy of large-scale master plans with a fixed timeline for implementation, to approaches that encourage smaller scale, market driven developments. In Assen, the challenge is how to use such an approach to convert a former industrial area into housing. The municipality wants iconic buildings (row-housing and apartment buildings) to be placed at designated locations on the site as start-up developments. The Rouen site in France (fig.7) is a mixed industrial and housing area by the River Seine. The project brief calls for the insertion of processes on the different scales affecting the site, such as a station that will connect to the rail network in 10 years' time, or urban development along the Seine, plus connections across the site linking the two banks of the river through the island of Isle Lacroix.

Transition as the challenge for architecture-as-urbanism

Surprisingly, we find that conditions of uncertainty, instability and irresolution have been part of city-making since the beginning of the modern era⁴. "Project Zagreb", initiated by the same authors, explicitly addresses the question of how architecture and urban planning can operate effectively and innovatively under conditions of instability. They introduce the notion of transition as a perpetual state of instability with uncertain outcomes, not as a passage from one stable condition to the next. They investigate how architecture operates in such conditions and – more interestingly still – they find new forms of architecture that are engendered by such transitional conditions. They show how architecture moves from urban form to urban

practice, attributing a leading role to agency. Such findings show how architects and planners in 20th century Zagreb developed new strategies for creatively engaging the transitional and open-ended in order to accommodate the state of irresolution. They showed how architectural projects absorbed the unrealised objectives of partially implemented master plans. They also pointed to the incremental value of architectural projects that prepare the ground for the emergence of later projects.

However, a danger along with a frustration emanates from the North American architectural community regarding architecture's disengagement from the city because of increasing instability coupled with the domination of privatized urban development. Even if the European city (specifically the North-Western European city) still largely maintains "Urban Continuity Plans"⁵, both instability and privatized urban development are on the rise. By studying the strategic nature of the re-engagement of architecture with the city, in urban settings differing from those of Western Europe but with increasing similarities, we could therefore inform the Europan debate. In addition, by contributing to this strategic approach through Europan practice, we could clearly demonstrate to a larger audience the relevance of Europan's rich architectural output of intentions and actions.

The concept of Fast-Forward Urbanism, introduced by Cuff and Sherman, was born out of such frustration, out of the quest for new ways of engaging architecture with the city. In fact, Fast Forward Urbanism advances the following four assertions: first, we cannot rely on the physical continuity of built development, therefore it is by mastering jump-cuts that the city and architecture could mutually support each other. Second, mastering jump-cuts involves the ability to embed design to strategic purpose within the operating system of the existing city; in other words, a thorough knowledge of how city-making works is crucial for architectural practice. Third, giving agency to everyday bottom-up urban activities is valuable in understanding how the city evolves organically, taking the small steps that everyday urbanism endorses. However, this is not enough for urban development, since the flow of capital is usually top-down, both through public, and now increasingly through private, channels. Fourth, to avoid a simplistic division between top-down and bottom-up approaches, the architect-urbanist needs to perform a more crucial role as a double agent whose interests coincide alternately with the client (municipality or private investor) and with those affected by the project's implementation.

The quest for new forms of architectural engagement with the city has been Europan's preoccu-



7 - ROUEN (FR)



18

12 - WIEN-KAGRAN (AT), RUNNER-UP - KALEIDOSCOPE
> SEE MORE PXX



13 - KUOPIO (FI), RUNNER-UP - SOMEWHERE OVER THE TRAIN FLOW... > SEE MORE PXX

private ground situated on the top of this volume serves the residential programme that extends into the building further up.

In the case of the runner-up project in Kuopio, (FI), *Somewhere over the train flow* (fig.13), we see a rather dense linear building armature but we also get a multi-bridge that covers the train rails and connects the project site to the adjacent area. Its disguise lies also in the fact that it is positioned horizontal to the railway tracks, not vertical as one would expect a bridge to be. The porosity of the ground floor of the buildings makes possible a multi-crossing over the rails via a major linear public space.

"...the building aims to kick-start the awareness of the site and the transformation process" in the words of the winning team in Assen (NL), *Embrace the present* (fig.14), but also partly in the words of the project brief itself. In this case, we see a linear residential block but we also get a multi-infrastructure that redefines the existing canal and repurposes part of it as a small harbour with private boats. In addition, it sacrifices its roof-top for a parking garage accessed by electrically operated elevators, further emphasising its "Trojan Horse" quality. Its durable linear structure seeks to work like Renzo Piano's "casa evolutiva" (references from the interview), available for appropriation by its future users.

In the runner-up project at Vila Viçosa (PT),

we see a *Tupperware party* (fig.15) and we also get a major linear public space partially covered by an elaborate canopy. In fact, the party is an example of how the infrastructure performs. The team aims to trigger awareness of the site and to foster the transformative process by events, in a way reminiscent of the endless field of Superstudio in the 1970s and the relational systems of SANAA's "Field Party". The proposed new buildings, however, seem redundant given the current inoccupancy of the site's building stock.

Mighty Unfoldings

In this group of projects we focus on the methods that the teams suggest for implementing their proposals. The fact is that operating in a state of transition neutralises any confidence in the exactness of future end-states and their reverse phasing into the present. Increasingly in European sessions, therefore, the teams formulate both the content and method of implementation through alternative scenarios, blueprints and roadmaps for action. We can see such approaches emerge explicitly as far back as European 6 in the previously mentioned article by Amphoux, where he introduces a definition of the project's complex context that addresses the interweaving of the "what" and the "how" in the heart of "architectural urbanism" (physical,

temporal and pragmatic aspects of the project context). A similar approach was introduced by the author for a study on the European 5 results¹¹. In examining the European 12 projects, we see how they develop a complex package of this kind first by multiplying the time-related agents in the project, which become mechanisms for adding value. In other words, a back and forth trajectory takes place between the "what" and the "how", to maintain both open-endedness and specificity. The "Mighty Unfoldings" group



14 - ASSEN (NL), WINNER - EMBRACE THE PRESENT
> SEE MORE PXX

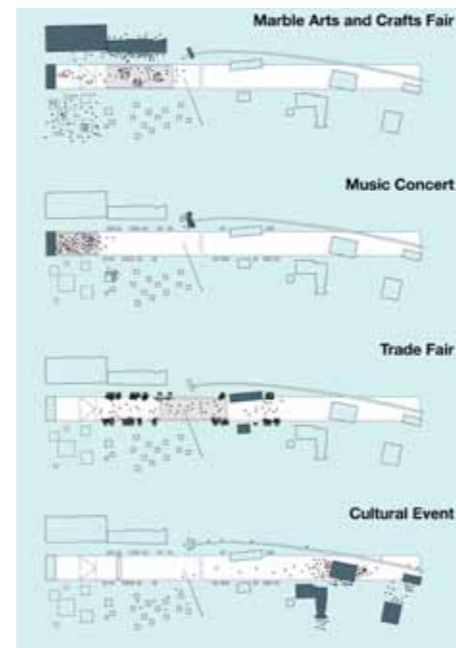

15 - VILA VIÇOSA (PT), RUNNER-UP - TUPPERWARE PARTY
> SEE MORE PXX



16 - ROUEN (FR), WINNER - QUE M'ANQUETIL? > SEE MORE PXX

consists of the winning project in Rouen (FR), *Que m'Anquetil?*, the runner-up in Donauwörth (DE), *Multiple city* and the winner in Vila Viçosa (PT) *Between landscapes*.

Multiplying time-related agents begins with the unearthing of existing temporalities hidden from plain sight, the temporalities of larger urban/natural territories. Sometimes these can be identified by simply establishing synergies between professions in the teams, as is the case with some of the E12 sites: the unearthing practices of landscape architects and urban planners combine with those of architects.

In fact, programmes and uses embody such temporalities, which inform the winning projects. The concept of pioneer uses and spaces, coined by the winning project in Rouen (FR), *Que m'Anquetil?* (fig.16), uncovers a different approach from those frequently encountered in European. In fact, we realize that the temporal events are not just time fillers until the final project takes over, but become active and valuable agents which engage new audiences with

the site, thereby actively influencing its future. They catalyse stop-action frame sites by adding value and thus opening up new possibilities. We find an emblematic winning project back in the European 9 session in Bordeaux (FR), *La ville plus près* (Bringing the town closer), where the project was supposed to grow from the site through the active agency of pioneer uses.

Why wait for the next 10 to 20 years to benefit from urban dynamics through connection to the railway network? Let's start now! Let's begin by harnessing the timeframes of the existing city to infiltrate the island-site by stitching together existing soft mobility networks and by offering attractive living by the waters of the Seine (*Que m'Anquetil?*, winning project, Rouen (FR)). In the case of the runner-up project in Donauwörth (DE), *Multiple city* (fig.17), we see a polarity being created by plugging the former military camp project site into the urban archipelago's transport infrastructures. By this means, the project is transformed into a device for managing urban flow. The plug-in device is cele-



17 - DONAUWÖRTH (DE), RUNNER-UP - MULTIPLE CITY > SEE MORE PXX



18 - VILA VIÇOSA (PT), WINNER - BETWEEN LANDSCAPES
> SEE MORE PXX

brated through a red, ribbon-like ramp, which overcomes the problems of the big level difference between the city and the project site. In the winning project in Vila Viçosa (PT), *Between landscapes* (fig.18), the abandoned project site gets some help by recruiting the extended former industrial area through an "à la carte" matrix of actions.

All three projects recruit larger territories to sidestep the absence of urban dynamics. In other words, they allow everyday temporalities from adjacent territories to revitalize the project sites, in tandem with the unearthed temporalities of the site itself. By hybridising temporalities, they bring added value to the sites.

Another way to add to the panoply of time-related project agents is through calls for open design initiatives, under which pioneering urban actors are invited to join an "urban brain storming". In the case of the *Que m'Anquetil?* winning project in Rouen (FR), the team delivers an impressive matrix of connections between project instigators (municipality, SNCF, region, etc.), urban pioneers (individuals, associations, schools of architecture, art, communication and advertising, ministry of culture, etc.) and pioneer uses and spaces. The nature of these uses and spaces may be either ephemeral or evolutionary, temporary or permanent. In the case of *Multiple*

19

In quest of urban eco-rhythms

Thinking about urban eco-rhythms means exploring and understanding the relations and interactions between the elements and living beings that constitute inhabited environments. As dynamics of interpenetration, interdependency and inter-engenderment, whether between climatic, tectonic, mechanical, chemical, biotic, economic or cultural factors, they relate to a whole and to parts, to singularities and a globality that encompasses and arises from interactive diversities. The challenge now is to understand and imagine other forms of transformation based on the resistances and resources of milieus, in other words alliances of different kinds that seek to capture, reveal, preserve, distribute, revitalise, by linking both physio-biological factors and anthropological specificities. To anticipate how they thus coexist and co-evolve for the metamorphosis of urban milieus, is to conceive rhythms between natures and artefacts, ecosystems and anthropisation. Although the timeframes of nature and of "techné" are not the same, they are both modes of production whose principal is generation, as evidenced by their etymology. For the word "nature", from the Latin "natura", means constant regeneration, and the root of the word "technique" is the Indo-European "tik", which means "to engender".

Making nature and artifice coexist

The idea of the eco-adaptable city means envisaging fruitful new alliances between the rhythms of the city and of nature. Urban nature, nature in the city, eco-city, a proliferation of terms that



1 - FOSSES (FR), WINNER - THE AMATEUR... MAKES WHAT IS UNPREDICTABLE POSSIBLE... > SEE MORE PXX

Arousing strong emotions, as well as ethical and aesthetic reassessments, it means water, earth, air, fire, fauna and flora, the rhythm of the seasons, of day and night, of the heart and of breath or of birth and death. Both wild and tame, it carries threat but also peace and regeneration. Many forms of hybridisation are now emerging at different scales – climatic, landscape, eco-architecture, reasoned density – with the aim of preserving woodland and farmland, green streets and roofs, gardens and parks, of nurturing fertile soil and biodiversity, urban agriculture, recycling, the seasonal cycle, coexistences, all approaches to a new city-nature. However, it is now crucial to the reconfiguration of modern cities to examine the capacity for resilience of milieus, the capacity to overcome trauma. In order to encourage the dynamics of revitalising alliances and to protect against natu-



2 - FOSSES (FR), RUNNER-UP - CROSSINGS-OVER > SEE MORE PXX

ral catastrophes, as well as catastrophes arising from human action, different forms of transaction between local and global are employed, such as setting the boundaries and porosities needed between city and country, urban land and farmland, techné and physis. In the recreation of conditions suitable for inhabiting and cohabiting, the quality of air, water, wind, streams and rivers, of fertile land, the living world, biodiversity, phytoremediation, ecological corridors and desirable forms of decontamination, can only be attended to and measured in relation to the distinctive character of places, the diversity of cultures and ways of living together, but also to eco-



4 - HÖGANÄS (SE), RUNNER-UP - URBEDIBLE > SEE MORE PXX



3 - HÖGANÄS (SE), WINNER - TWINPHENOMENA > SEE MORE PXX

It is these corhythms between nature and culture that constitute the challenge of regenerative re-connections in urban milieus. To exploit them requires a radical change in the way territory is perceived, managed and invented. Three particularly significant forms of nature are primarily deployed in the European 12 session with respect to architectural approaches that seek to capture, reveal, handle and balance the relations between nature and artifice:

- productive nature;
- nature as structure;
- reparatory nature.

These approaches entail re-evaluations and

interweavings between long and short timeframes, permanence and instability, involving new kinds of programmes and rhythms that redefine the engagements between near and far, the micro and the macro.

Productive nature

Treating agriculture as the matrix of the urban lends vigour to the concept of the urbano-rural or the rurban. The Fosses site in France, in the heart of the rural village, is an urban fringe on the edge of natural and agricultural land. The importance of stabilising the boundary between town and farmland and to reverse the process of urban sprawl, in which fields are no more than an implicit land reserve for urban growth, which takes precedence, is at the centre of the concerns of the winning teams. With their project *The Amateur... makes what is unpredictable possible...* (fig.1), the winning team increases village density to protect the agricultural landscape and employs scenarios for connecting actors: an immaterial dimension is stressed in order to stop the momentum of material consumption. On the same site, the runner-up team with *Crossings-over* (fig.2) also chooses to create a rurban landscape of small-scale bio-intensive market gardening. The aim is to employ limited financial and material resources

with such a nature is to activate the resilience potential of a milieu. It should be seen alongside vital cycles and synergies to protect against catastrophes and generate other possibilities for urban life.

At Kaufbeuren in Germany, the runner-up project, *Long-lasting landing landscaping* (fig.10), seeks to achieve renaturing by creating vast "reserve" areas. As for the winning project, *Fasten your seat belt!* (fig.11), it seeks to remake the city by restoring value to natural spaces and the connections between landscape, territory and architecture.

At Vichy Val d'Allier in France, where the brief is to "build the economy of the future within a woodland park" in the conversion of a large industrial site, the winning team with its *Pioneer fringes project* (fig.12), in its quest for greater hybridisation, draws on very close analyses of the territory with the aim of combining activity development with regeneration through water impound-



13 - VICHY VAL D'ALLIER (FR), RUNNER-UP - CLEARINGS ARCHIPELAGO
> SEE MORE PXX

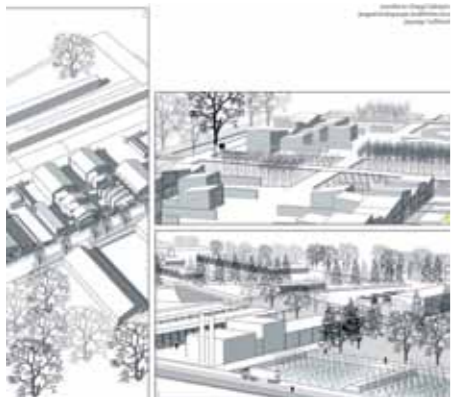

12 - VICHY VAL D'ALLIER (FR), WINNER - PIONEER FRINGES
> SEE MORE PXX



11 - KAUFBEUREN (DE), WINNER - FASTEN YOUR SEAT BELT!
> SEE MORE PXX



15 - MILANO (IT), WINNER - LANDSCAPE TRANSITION > SEE MORE PXX

ment and functional autonomy, whether from the perspective of energy production or waste recycling. Periods of latency are also allowed for through flexible phasing. The runner-up team, with *Clearings archipelago* (fig.13), emphasises forms of decontamination combined with the production of a regenerated landscape, and the special mention project, *Arboripôle*⁵ (fig.14), is characterised by an attitude which, while criticising an often excessively limited concept of eco-neighbourhoods, stresses the importance of the long-term in the encounter with natural rhythms for "eco-responsible reappropriation".

At Milan in Italy, still counting on the resources of natural rhythms for both decontamination and for potential eco-development, the winning team, with its *Landscape transition* (fig.15) project, seeks to fulfil the brief for the sustainable development of the Porto di Mare site by creating a large connecting territory as source of resilience, introducing a large urban axis while maintaining the farmland plot structure. The project provides for the infiltration of rainwater and its capture in a network of water meadows.

Towards an architecture of milieus

It would seem that the seriousness with which eco-rhythms are taken in urban-architectural projects is contributing to a radical renewal of architecture, by prompting designers to work with the cycles of life, human beings and the universe, and from sensory and aesthetic experiences of a different kind. The desire to maintain the large equilibriums and transformations that structure and link human and nonhuman, is leading to the emergence of composite, hybrid and regenerating dynamics, complex lines and interweavings of another kind. This constitutes a source of reinvention in the forms of life and the city, whether through changes of focus, readjustments to passing time or transmutations. The challenge is to devise intermediary arrangements between the large, long-term territorial scales, the site and architectural interventions, but also to express poetic rhythms that can be shared. Which is a way of committing to an architecture of milieus that are capable of cultivating other attentions, other forms of sharing and other regenerative encounters.

Dynamic urban platforms

Revitalising currently unattractive public spaces needs consideration on a broader scale than the immediate site environment. Even if these spaces are sometimes small in scale, they are strategic levers for activation on an urban level. Their impact in terms of identity and image often exceeds their physical limits and calls for a wider transformation of the existing fabric. Blind spots that have never had adequate use, or places whose initial functions are now obsolete or out of sync with the requirements of the inhabitants, can serve as platforms for activation and appropriation to mobilise the local population or a broader public. The development or redevelopment of these areas can be approached in many ways: in the form of refreshment by multifunctional spaces, with temporary or extendable structures acting as acupuncture, or as a trial balloon to put a site on the map, initiate private co-financing or investment and find new rhythms of intensity.

AALBORG (DK)	XX
BITTERFELD-WOLFEN (DE)	XX
BUDAPEST (HU)	XX
DON BENITO (ES)	XX
GJILAN (KO)	XX
KRISTINEHAMN (SE)	XX
MARSEILLE PLAN D'AOU (FR)	XX
SAINT-HERBLAIN (FR)	XX
SCHIEDAM (NL)	XX
WITTENBERGE (DE)	XX

LOCATION BÆRUM - HAMANG,
SANDVIKA
POPULATION BÆRUM
116,000 INHAB.
STRATEGIC SITE 164 HA
SITE OF PROJECT 25 HA

SITE PROPOSED BY
CITY OF BÆRUM
OWNER(S) OF THE SITE
VARIOUS PRIVATE OWNERS



INTERVIEW

OF THE SITE'S REPRESENTATIVE
EUROPAN NORGE

Presentation of the site within the context of the city development and in terms of strategy

The post-industrial area of Hamang in northern Sandvika, the urban centre of Bærum municipality, is about to undergo a fundamental transformation. The E16 highway, which currently splits the area, will be rerouted into a new tunnel, opening up this central part of the city for new uses. Competitors were asked to propose a strategy for the development of a carbon neutral area in one of the Oslo region's most central nodes. The brief was to provide a concept for the programme, landscape and built volume that gives the site a new identity. The River Sandvika runs through the site, providing a rich biodiversity. The city wants a plan that demonstrates how the river can be integrated into the urban fabric and utilised more actively, while protecting the local ecosystem. The competition seeks a strategy for the use of the waterway, including plans for infrastructure as well as new programmes for the river and riverbed. Climate change imposes restrictions on flood risk areas. An important part of the task is to find suitable programmes and infrastructure that can adapt to various water levels.

How can the site be integrated in the issue of the adaptable city and how do you consider this issue?

The municipality wanted to use the competition to explore the site and city's capacity for growth. At the same time, demographic and programmatic factors are essential. Who can live here? What can people do here? It is important that the site reflects a regional context, but at the same time develops a local identity, complementing the other areas in Sandvika. The site is part of the Futurebuilt programme for carbon neutral urban development and competitors are encouraged to show how the objective of climate neutrality can be met.

At the time of sustainable development coupled to an economic crisis, have you already defined a specific strategy for the urban development of the site?

The Hamang site is not affected by economic crisis, quite the contrary. The Hamang site's main challenges can be summed up in the following key points: the ability to absorb growth, adaptability to Sandvika and the greater Oslo Region, how the flood restricted riverscape can be programmed, reuse of former industrial buildings, and finally how to introduce smaller, temporary projects on site, adapting over time. The jury picked a winner and a runner-up that complement each other very well, one focusing on landscape, the other on architecture. The municipality, the landscape architects and architects are now (February 2014) negotiating a contract that will regulate the work on a zoning plan for the site as well as an activity plan for the riverbed.





Working on the edge

Social Riverscape

Team point of view As a strong structuring component, the River Sandvika forms the base for the new development. Social programs are placed along the river to create natural destinations in the area, making the river an active part of the city. The built fabric and nature together establish a new social riverscape. The buildings live with the river, adjusting to reflect its character, creating a new way of living with the river.

Social Riverscape is a structure that grows around the community of Sandvika. Different programs are placed strategically along the river, generating different kinds of rhythm. These social rooms provide the opportunity for multiple encounters, linking local and regional through different neighbourhood features, jobs and housing.

Jury point of view The proposal has an analytical and intellectual approach that is of great interest. It shows how efficient new public transport increases the needs of communities on the site and how they could be created. The river space and the river itself are the base for the proposed new development. The keywords are rhythm, nature, urban development. The rhythms of people, built spaces and nature are very well described and can also be seen in the proposed structure.



Field of possibility

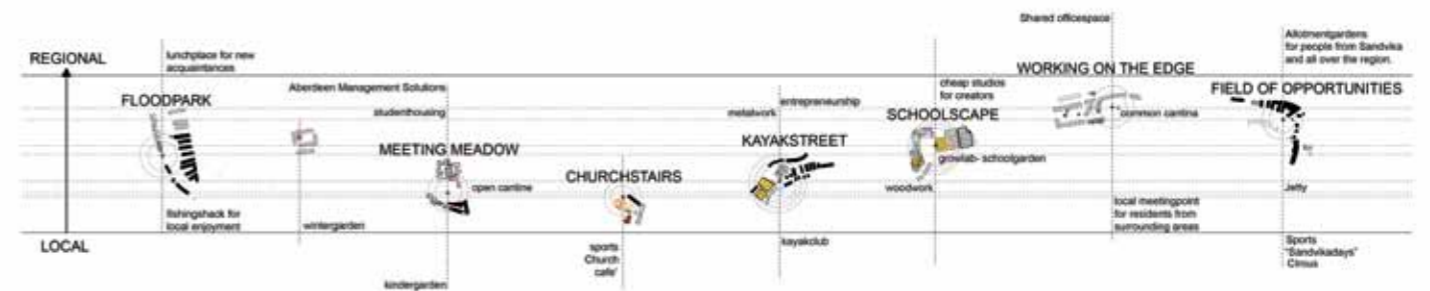
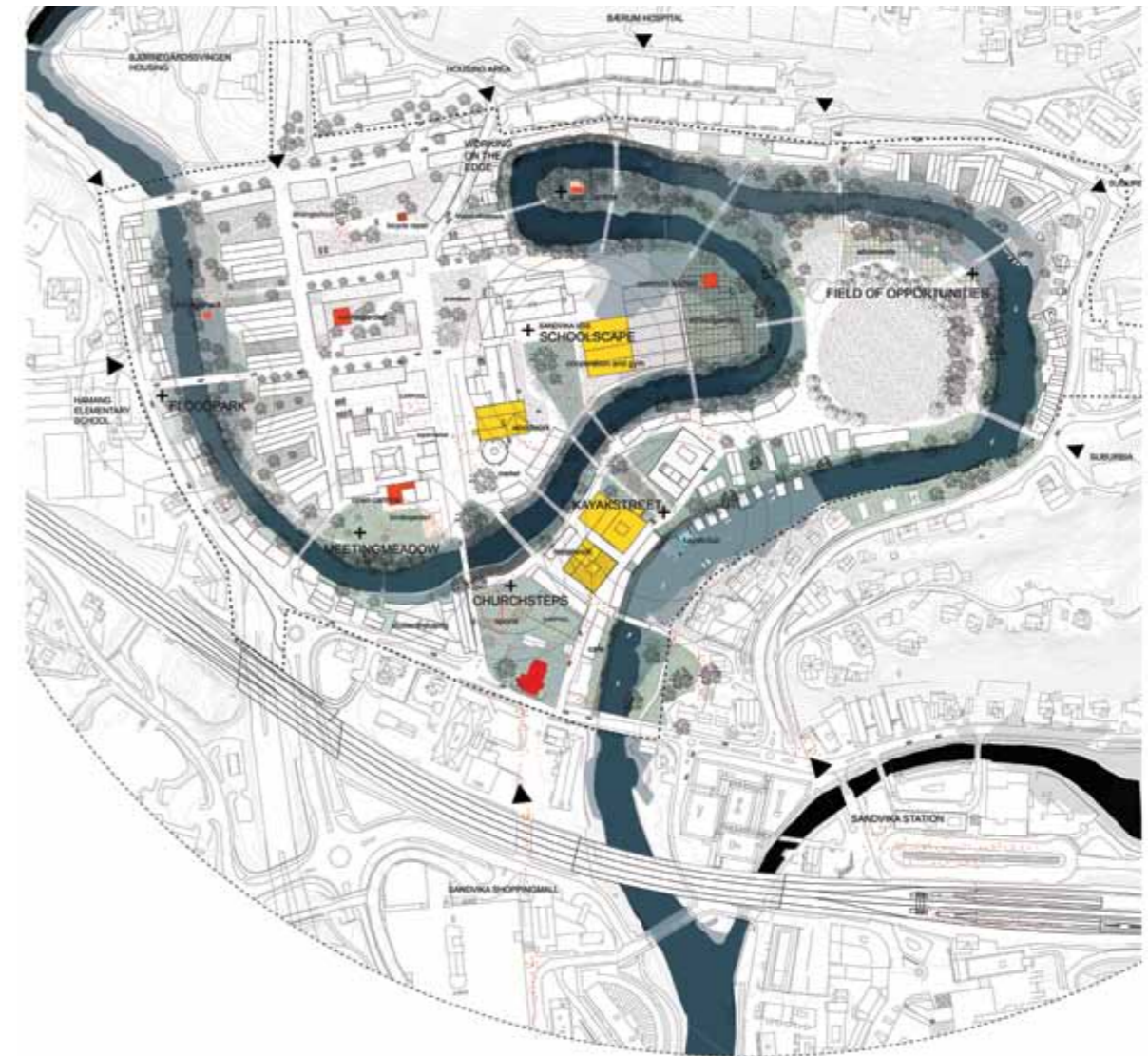
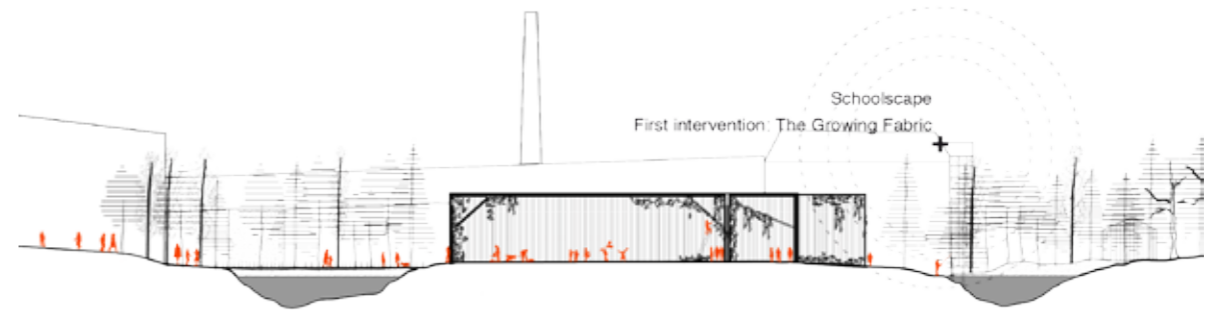
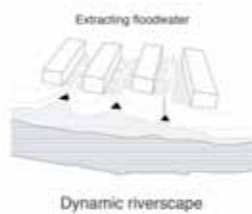
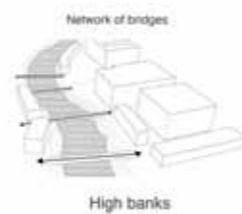
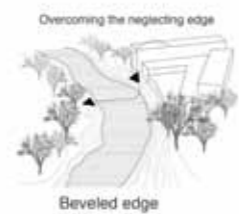

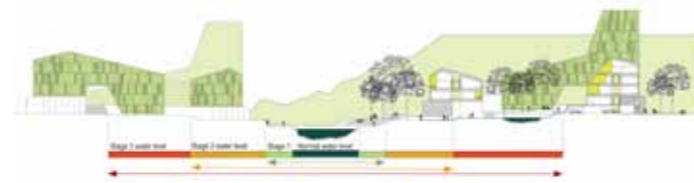

Elasti-city

Team point of view The main goal in this project is to bind together a rich but complex milieu: the different city districts, topography and nature, history and expanded timeframes...

ELASTIC AXIS is a fluctuating spine linking Hamang with the city of Sandvika and the fjord. Two interconnected rings, integrating public transport, a mixture of programs and public spaces, bind Hamang to East and West Sandvika.

ELASTIC RIVERBEDS is the design strategy for managing the fluctuations in water levels and improving flood protection. Terraced sequences of flexible and permeable spaces enhance retention capacity along the watercourse, the adaptability to changing conditions. The older buildings on the site accommodate new uses and the new mixed scale blocks permit future adaptation to density and programmes.

Jury point of view Elasticity deals with the area's need for density by proposing a building typology that resolves both collective and individual programmes. Kjørbotangen is retained as a natural and recreational area without built structures. Programmaticaly, the project distributes mixed uses throughout the big semi-closed blocks, deploying a well-developed overall section that relates the river banks to the interior of the blocks. This provides a public solution for both the river edges and the collective interior spaces.



Hamang Riparian Zone

Team point of view The essential theme of this proposal is to let the river act naturally. Processes of sedimentation and erosion, flooding and water course alterations are given priority; the river is the governing factor in the urban design. A semi-wilderness will develop spontaneously, a space for exploration, education and recreation. The proposal is concerned with the idea of rhythms: natural, social and spatial. The temporal aspect of the site's uses and the seasonal cycles form the program structure. Adaptability is key: each place within the site can be used differently at different times through the idea of time-based programming. Interaction between the different populations on the site is encouraged by a large dining table used by elderly residents, school students and workers.

Jury point of view The project situates the development of the site within the topographical and ecological context of the Sandviks River and its hydrological dynamics. The proposal not only addresses seasonal flooding but also the meandering that occurs naturally over time with unchannelled watercourses. It seeks to accommodate these future changes by giving space to the river, on the principle that it is this riparian system –including the specific and diverse flora and fauna that develop over time – which defines the character of the site.

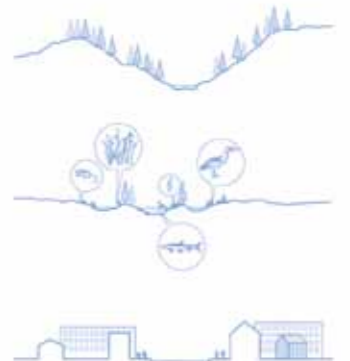
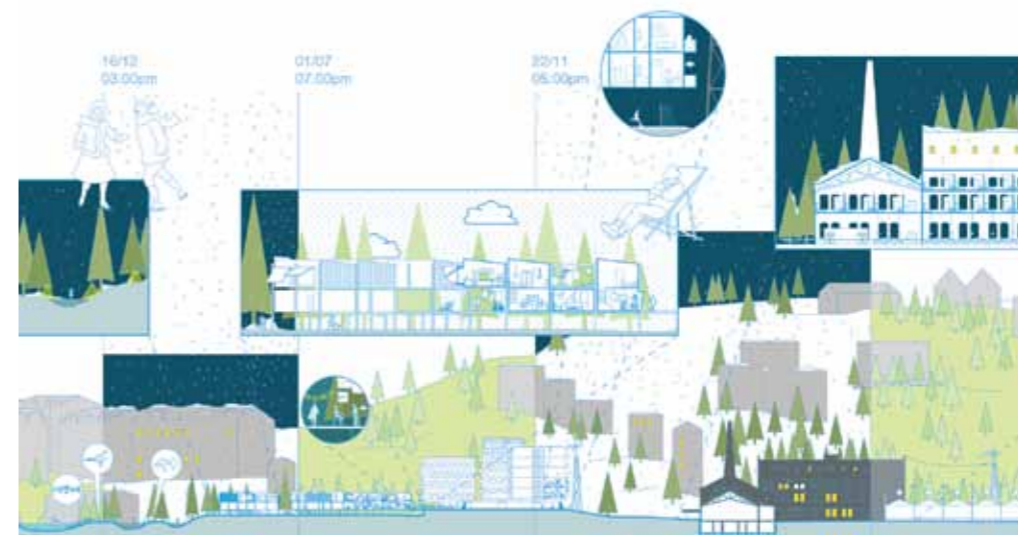

ALMADA - PORTO BRANDÃO

PORTUGAL (PT)

LOCATION ALMADA – PORTO BRANDÃO
POPULATION CITY 174,000 INHAB. - CONURBATION 2,822,000 INHAB.
STRATEGIC SITE 117 HA
SITE OF PROJECT 8 HA

SITE PROPOSED BY
CITY OF ALMADA
OWNER(S) OF THE SITE
SEVERAL (PUBLIC AND PRIVATE)

INTERVIEW

OF THE SITE'S REPRESENTATIVE

MARIA AMÉLIA PARDAL, COUNCILWOMAN FOR PLANNING, TERRITORY ADMINISTRATION AND CONTEMPORARY ART

Presentation of the site within the context of the city development and in terms of strategy

Almada's privileged geographical position, natural wealth and high environmental quality, resulting from its location in the Tagus estuary and on the Atlantic waterfront, give the town close links with the water and great competitiveness in tourism, recreation and leisure in the regional and national context, with the potential to generate new dynamics.

Porto Brandão is a unique location, a key site in its proximity to the Lisbon Metropolitan Area's second largest university campus, the municipality's Research and Development (R&D) hub under the Almada-Monte de Caparica Municipal Master Plan, and also in its direct connection to one of the Lisbon Metropolitan Area's largest centres of tourist attraction – Belém.

For the site area, the strategy encompasses the regeneration of the riverfront's existing industry, by defining an axis of tourist activities, recreation and leisure, and the expansion and consolidation of the university campus with strong connection to R&D activities.

How can the site be integrated in the issue of the adaptable city and how do you consider this issue?

There is a clear dichotomy between the description of what Porto Brandão is today and previous reports on this same site.

Historically, it played an important role in connecting banks; today, however, this has been lost, though it is still geographically central and part of a primary urban infrastructure network.

We believe that this reality can be transformed by identifying suitable programmes that will attract young people seeking new or different ways of living and working, and form an urban community open to the world, based on recovered and valued traditions. The challenge is not to make Porto Brandão adaptable, but to create conditions for the community itself to be the agent of transformation and the territory to become a dynamic and adaptable foundation for such a process.

At the time of sustainable development coupled to an economic crisis, have you already defined a specific strategy for the urban development of the site?

Since this is a very complex territory, there can be no single, specific solution, but rather a set of initiatives, connected in time and space, which seek to create the conditions for the development of Porto Brandão.

Exploiting the natural resources of the area, investing in traditional fishing and wine production activities, recovering in gastronomic reputation, revealing the historical and cultural legacy associated with the processes of urban regeneration, as have been successfully tested (eg. Cacilhas) are potential ways to generate value and social and economic dynamics.

The articulation with the Lisbon Port Administration for the rehabilitation of the riverfront and the regeneration of the dormant port activities, with public transport operators to reinforce the network, with the University as a privileged interlocutor in the field of Research and Development, with owners / developers and the community, are further key elements of Porto Brandão's urban development process.

330



331





VALPOLICELLA, SOAVE CASTLE



ERACLEA MINOA, GREEK THEATRE



STRATEGIC SITE

Porto novo

Team point of view *Porto Brandão*, situated in the Almada suburbs, constitutes a potential "urban catalyst" because of its territorial and landscape peculiarities.

The project aims to give *Porto Brandão* the role of a new centrality on the Lisbon "outro lado", in order to promote the transformation of the metabolic city and revitalize its socio-economic and cultural scene. In particular, certain project aims like the waterfront development and the new harbour, the revitalization of the area's economy through the re-introduction of wine production around the *Lazareto*, and the introduction of a public transport line, will help to create a sense of "place", in response to the specific needs of different generations in terms of "space" and "program facilities", while enhancing their active role in city life.

Jury point of view By betting on a low-density solution and using the landscape as a working tool, remodelling, reusing and reinforcing its values, this project achieves change through a diversified strategy that opens up a range of adaptability options. The methods used to transform the landscape – cultivating vines, work on the riverfront, a new geometry and a strong image for the new "port" – reveal a capacity for reactivation and promote a "renewed" identity.



PORTO BRANDAO, LAZARETO AREA, 2025



PORTO BRANDAO, SILOS AREA - AMPHITHEATRE, 2025



AXONOMETRIC VIEW OF PROJECT SITE



PORTO BRANDAO, "PORTO NOVO", 2025



ROMAN COIN, TRAJAN'S HARBOUR



SECTION

334



Punctuation

Team point of view Inspired by the distinctive topography of the south bank of the Tagus, the project firmly orchestrates a number of contrasting functions. Each activity is laid out not so much on a surface as within a thickness, free to extend across the territory as it requires, and possibly to cross the river towards Lisbon. In Porto Brandão, the heart of the operation, several axes of differing thickness are remodelled. Their encounter creates focal points for the introduction of public spaces, whose conception is based on the principles of relation to the earth and sky. Each one of these "events" is mounted in different phases, with time gaps that allow real uses and practices to be expressed and to influence the form these punctuations take.

Jury point of view The project, with its clear and novel strategic solution of removal or reconstruction and further recovery of the pre-existing matrix, reveals the potential and feasibility of the approach to adaptability. It demonstrates sensitivity in detailing the various programmes for uses, particularly in its relationship with topography and pre-existing urban fabric and it communicates different "environments" with great care and detail.

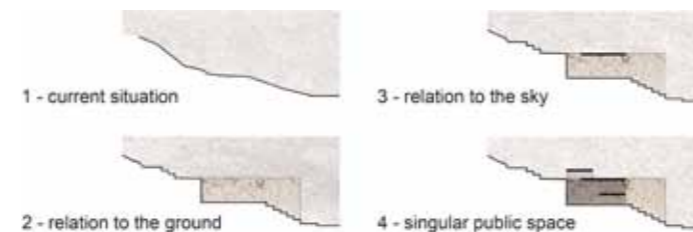
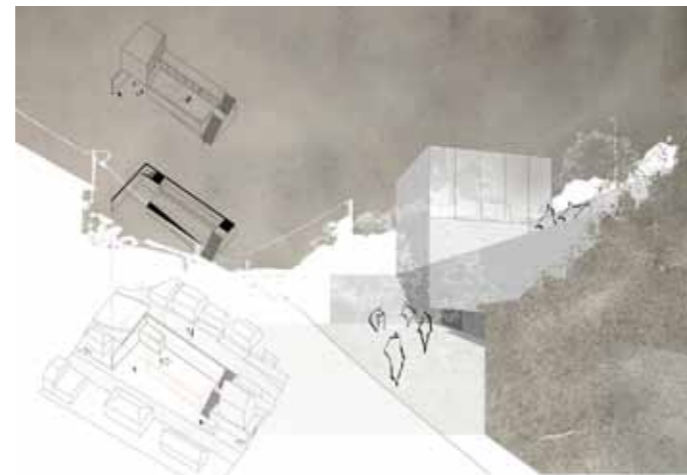

HOUSING

Timeline

Team point of view Various events have affected Porto Brandão, a place today forgotten by time, but possessing a distinctiveness that makes it unique in the context of Tejo estuary. Marked by interventions that radically altered the local topography, the waterfront between Trafaria and Almada is atypical and inaccessible. The oil industry's occupation of the area has led to segregation and discontinuity. The legacy serves as a starting point for a recovery strategy, by reordering mobility and improving activities that were once the engine of the local economy. The reintegration of the site into the socio-economic context of Almada will generate polarities capable of promoting the development of the whole south bank of the Tejo River. Proposed "lines" will restore lost cohesion and regenerate the entire region, unifying different timescales.

Jury point of view The proposal very effectively tackles the formalization of various brief programmes, with a particular focus on the low altimetry installations. The urban design solution, with the proposed plaza and the functional reuse of industrial infrastructure, is effective in establishing separate connections to areas of high-intensity occupation. The various solutions are clearly represented and communicated, making their feasibility clear. Adaptability is achieved through a phased implementation of the design.



WATERFRONT AND HOUSING PLANS

1. PORTO BRANDÃO'S NEW MAIN SQUARE / 2. MARKET - REQUALIFICATION OF EXISTING BUILDING / 3. SHADING STRUCTURE / 4. MARKET EXTENSION / 5. PROPOSED WATERFRONT / 6. BICYCLE PATH / 7. GALLERIES - RETAIL/ BOATS BOX / 8. MUSEUM / 9. VERTICAL CONNECTION TO LAZARETO / 10. BAR / 11. NEW PLATFORMS / 12. COLLECTIVE STUDIOS - REQUALIFICATION OF THE OLD CANNED FACTORY / 13. RIVER TERMINAL / 14. PROPOSED JETTIES / 15. MARINA / 16. HOUSING - TYPOLOGY T3 / 17. HOUSING | MIXED TYPOLOGY T1 E T3 / 18. SCHOOL / 19. EQUIPMENTS / 20. PUBLIC GARDEN / 21. NEW ACCESS / 22. PEDESTRIAN PATH

335



REUSE OF INDUSTRIAL INFRASTRUCTURE



WATERFRONT



MASTERPLAN

Index

European 12, is:
51 sites
16 countries
14 national juries

170 winning teams:
43 winners
63 runners-up
64 special mention

BELGIQUE/BELGIË/BELGIEN



Urban/architectural order

MARTINE RIDIAUX (BE), ARCHITECT, DIRECTION OF OPERATIONAL PLANNING OF WALLONIA
BERNOIT DISPA (BE), MAYOR OF THE TOWN OF GEMBOLOUX

Urban/architectural design

ALAIN CASARI (FR), ARCHITECT, URBAN PLANNER, NANCY-METZ-PARIS
ALBERTO MOTTOLA (IT), ARCHITECT, DEMOGO, WINNER EUROPEAN 10, TREVISO
LUC HERZE (BE), ING-ARCHITECT, PRESIDENT OF ARALG, EUROPEAN 1 WINNER, LIÈGE
JEAN-MICHEL DEGRAEVE (BE), ARCHITECT, HABITAT-CONCEPT, EUROPEAN BELGIQUE V-P

Public figure

JAN KETELAER (BE), ARCHITECT, FORMER PRESIDENT OF NATIONAL COUNCIL OF ORDER AND OF ROYAL FEDERATION OF ARCHITECT OF BELGIUM

DANMARK



Urban/architectural order

ULRIK WINGE (DK), CIVIL ENGINEER AND MASTER OF PUBLIC ADMINISTRATION, HEAD OF CITY AND ENVIRONMENT DEPARTMENT IN THE MUNICIPALITY OF FREDERIKSBORG
STEPHEN WILLACY (DK/UK), ARCHITECT, CITY ARCHITECT OF THE MUNICIPALITY OF AARHUS

Urban/architectural design

JAN CHRISTIANSEN (DK), ARCHITECT, ASSOCIATE PROFESSOR AND RESEARCHER, THE ROYAL SCHOOL OF ARCHITECTURE, COPENHAGEN AND PROJECT CONSULTANT AT THE STATE-OWNED COMPANY FREJA EJENDOMME
OLE SCHROEDER (DK), ARCHITECT, PARTNER IN THE ARCHITECTURAL FIRM TREDJE NATUR AND WINNER OF EUROPEAN 11
FREK PERSYN (BE), ARCHITECT, PARTNER IN THE ARCHITECTURAL FIRM 51N4E
ANDERS MELSOM (NO), ARCHITECT, OWNER OF THE ARCHITECTURAL FIRM MELSOM ARKITEKTUR

Public figure

MORTEN STRAEDE (DK), SCULPTOR

DEUTSCHLAND – POLSKA (ASSOCIATED)



Urban/architectural order

KARIN SANDECK (DE), ARCHITECT, BAVARIAN STATE MINISTRY OF THE INTERIOR MUNICH

Urban/architectural design

HILDE LÉON (DE), ARCHITECT, LÉONWOHLHAGEWERNIK, PROFESSOR FOR ARCHITECTURAL DESIGN AT LEIBNIZ UNIVERSITY HANNOVER, BERLIN
KLAUS OVERMEYER (DE), LANDSCAPE ARCHITECT, OWNER OF THE FIRM URBAN CATALYST, PROFESSOR FOR LANDSCAPE ARCHITECTURE AT BU WUPPERTAL, BERLIN
FLORIAN FISCHER (DE), ARCHITECT, PROFESSOR FOR ARCHITECTURAL DESIGN AT OHM-HOCHSCHULE NÜRNBERG, MUNICH
JULIO DE LA FUENTE (ES), ARCHITECT, PARTNER OF THE ARCHITECTURAL FIRM GUTIÉRREZ-DELA FUENTE ARQUITECTOS, EUROPEAN 9 WINNER IN SELB, MADRID
ROLO FÜTTERER (DE), ARCHITECT, KAISERSLAUTERN

Public figure

KRISTIAAN BORRET (BE), ARCHITECT, URBAN PLANNER, BOUWMEESTER OF ANTWERP AND PROFESSOR URBAN DESIGN AT GHEENT UNIVERSITY, GHEENT

Representative european Polska

ONE REPRESENTATIVE OF EUROPEAN POLSKA JOINS THE GERMAN JURY TO EVALUATE THE PROJECTS SUBMITTED ON THE POLISH SITE: **JAKUB SZCZESNY** (PL), ARCHITECT, WARSZAWA

ESPAÑA



Urban/architectural order

SEBASTIÀ JORNET (ES), ARCHITECT, URBAN PLANNER, BARCELONA
VICTORIA ACEBO (ES), ARCHITECT, MADRID

Urban/architectural design

JOAO LUIS CARRILHO DA GRAÇA (PT), ARCHITECT, LISBOA
VÍCTOR NAVARRO (ES), ARCHITECT, MADRID
CHRISTOPHE HUTIN (FR), ARCHITECT, BORDEAUX
CLARA MURADO (ES), ARCHITECT, FORMER WINNER EUROPEAN, MADRID

Public figure

FREDY MASSAD (ES/ARG), ARCHITECT, JOURNALIST

FRANCE



Urban/architectural order

JEAN-MARC OFFNER (FR), DIRECTOR OF AGENCE D'URBANISME BORDEAUX MÉTROPOLE AQUITAINE, A'URBA
SERGE CONTAT (FR), GENERAL DIRECTOR OF RIVP (RÉGIE IMMOBILIÈRE VILLE DE PARIS)

Urban/architectural design

TANIA CONCKO (NL), ARCHITECT AND URBAN DESIGNER, AMSTERDAM
BRIGITTE MÉTRA (FR), ARCHITECT, METRA&ASSOCIATES, PARIS
JOÃO NUNES (PT), LANDSCAPER, PROAP, LISBON
PASCAL ROLLET (FR), ARCHITECT, LIPSKY&ROLLET ARCHITECTS, PARIS

Public figure

BERTRAND-PIERRE GALEY (FR), ARCHITECTURE DIRECTOR, MINISTRY OF CULTURE AND COMMUNICATION, PRESIDENT OF THE JURY

Substitutes

NICOLAS REYMOND (FR), ARCHITECT & URBAN DESIGNER, ATELIER NICOLAS REYMOND, PARIS
MARION VACONSIN (FR), ARCHITECT, LANDSCAPER, BOURIETTE&VACONSIN ARCHITECTURE URBANISM LANDSCAPE DESIGN SOCIETY, BORDEAUX

ITALIA



Urban/architectural order

PATRIZIA GABELLINI (IT), ARCHITECT, PROFESSOR, URBAN COUNCILLOR AT MUNICIPALITY OF BOLOGNA, BOLOGNA

Urban/architectural design

RODOLPHE LUSCHER (CH), ARCHITECT, PRESIDENT OF EUROPEAN SUISSE, LAUSANNE
ALFONSO PORRELLO (IT), ARCHITECT, PROFESSOR AT THE UNIVERSITY OF PALERMO - INDUSTRIAL DESIGN DEPARTMENT, FORMER PRESIDENT OF EUROPEAN ITALIA, PALERMO
FRANCO PURINI (IT), ARCHITECT, ESSAYST AND PROFESSOR, ROMA
JUAN MANUEL PALERM SALAZAR (ES), LANDSCAPE ARCHITECT, PROFESSOR OF ARCHITECTURAL DESIGN AT THE SCHOOL OF ARCHITECTURE OF LAS PALMAS, SANTA CRUZ DI TENERIFE
LAPO RUFFI (IT), ARCHITECT, EUROPEAN 10 WINNER IN MONTREUX, PISTOIA
VALERIA SASSANELLI (IT), ARCHITECT, RUNNER UP EUROPEAN 6 IN FRASCATI, ROMA